

# MUNICIPALITY OF STEWARTVILLE

PREPARED BY THE  
MINNESOTA DEPARTMENT OF TRANSPORTATION  
OFFICE OF TRANSPORTATION SYSTEM MANAGEMENT

IN COOPERATION WITH  
U.S. DEPARTMENT OF TRANSPORTATION  
FEDERAL HIGHWAY ADMINISTRATION

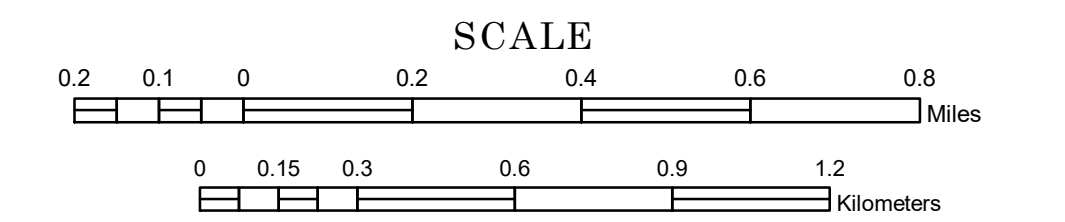

2020

Projection:  
Transverse Mercator  
NAD 1986  
UTM Zone 15



North American Datum  
of 1986

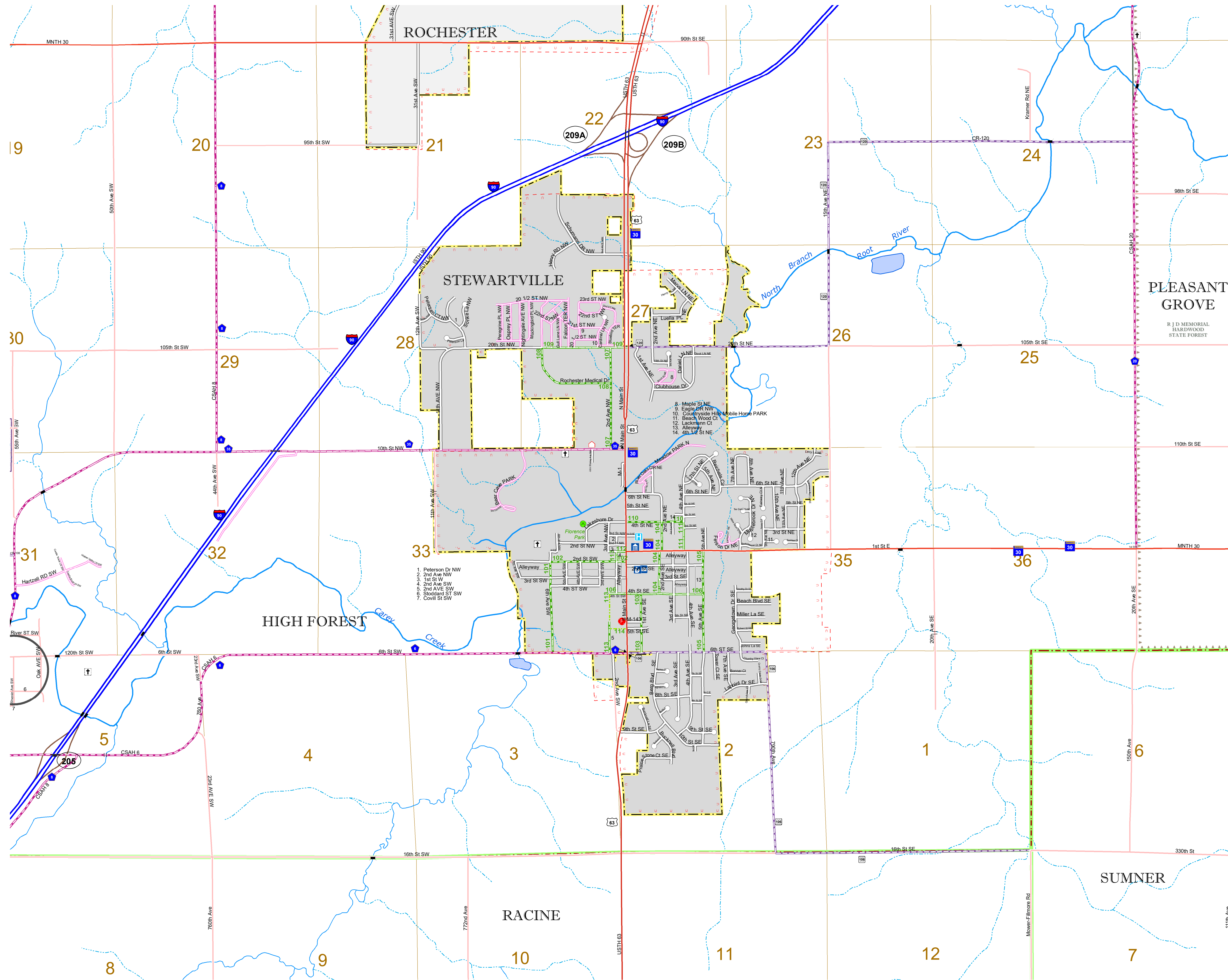

ROAD AND ROADWAY FEATURES	PUBLIC SERVICE FEATURES
INTERSTATE	MINDOT OFFICE
US HIGHWAY	MINDOT TRUCK STATION
MN HIGHWAY	HIGHWAY PATROL DISTRICT OFFICE
COUNTY STATE AID HIGHWAY	STATE TRAVEL INFORMATION CENTER
COUNTY ROAD	REST AREA (FULL SERVICE)
MUNICIPAL STATE AID STREET	REST AREA (VALET TOILET)
PRIVATE STREET/ROAD	WAYSIDE (VALET OR PIT TOILET)
TOWNSHIP ROAD	LOCAL PARK
UNORGANIZED TERRITORY ROAD	PUBLIC ACCESS POINT
RAMP OR CONNECTOR	FAIRGROUNDS
INTERSTATE EXIT	PORT OF ENTRY
GREAT RIVER ROAD	PARK AND RIDE LOT
OTHER ROADS	PRIVATE UNIVERSITY/COLLEGE
FRONTAGE ROAD	PRIVATE UNIVERSITY/COLLEGE
INDUSTRIAL PARKWAY	STATE HISTORICAL MONUMENT
COMMERCIAL AIRPORT	CULTURAL FEATURES
AIRSTRIP	HISTORIC DISTRICT
SEAPLANE	HISTORIC SITE
AIRPORT RUNWAY	MONUMENT
RAILROAD AND RAILWAY FEATURES	BOUNDARY FEATURES
EMPIRE BUILDER STATION (AMTRAK)	TRIBAL LAND
NORTHSTAR STATION (COMRAILER)	COUNTY
BLUE LINE	MUNICIPALITY
GREEN LINE	ADJACENT MUNICIPALITY
LONG BRIDGE (100' OR GREATER SPAN)	FEDERAL ADJUSTED URBAN AREA (2014)
MAJOR BRIDGE (20' TO 100' SPAN)	MILITARY
MINOR BRIDGE (5' TO 20' SPAN)	VOYAGEURS NATIONAL PARK
DAM	BOUNDARY WATERS CANOE AREA WILDERNESS
LOCK AND DAM	STATE PARK
STATE CAPITOL	REGIONAL PARK
FEDERAL COURTHOUSE	NATIONAL PARK
COUNTY COURTHOUSE	NATIONAL AND STATE FOREST
ARMORY	STATE FOREST
	NATIONAL TRAIL
	WILDLIFE REFUGE AREA
	WILDLIFE MANAGEMENT AREA
	HYDROLOGIC FEATURES
	RIVER OR STREAM (PERMANENT)
	LAKE, POND OR RESERVOIR
	STREAM (INTERMITTENT)
	DRAINAGE DITCH
	WETLAND
	ISLAND OR LAND
	REGIONAL WATERSHED

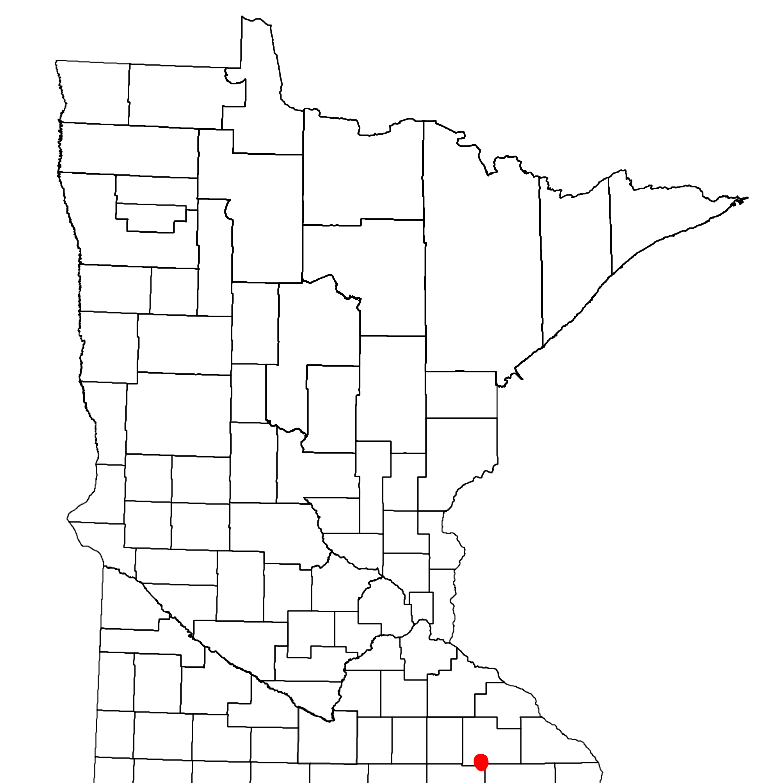

Population (U.S. Census 2010): 5916

To request information from this document in an alternative format, call 651-366-4718 or 1-800-657-3774 (Greater Minnesota); 711 or 1-800-627-3529 (Minnesota Relay). You may also send an e-mail to ADARquest.dot@state.mn.us. (Please request at least one week in advance.)

LAST EDITED ON 2-25-2020