

MUNICIPALITY OF OTSEGO

PREPARED BY THE
MINNESOTA DEPARTMENT OF TRANSPORTATION
OFFICE OF TRANSPORTATION SYSTEM MANAGEMENT
IN COOPERATION WITH
U.S. DEPARTMENT OF TRANSPORTATION
FEDERAL HIGHWAY ADMINISTRATION

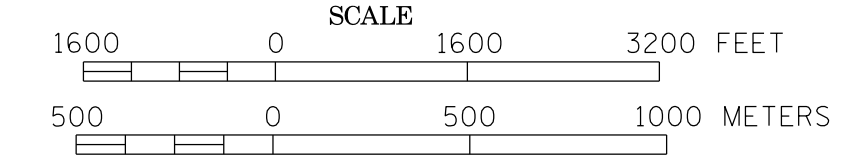

2015
BASIC DATA - 2013

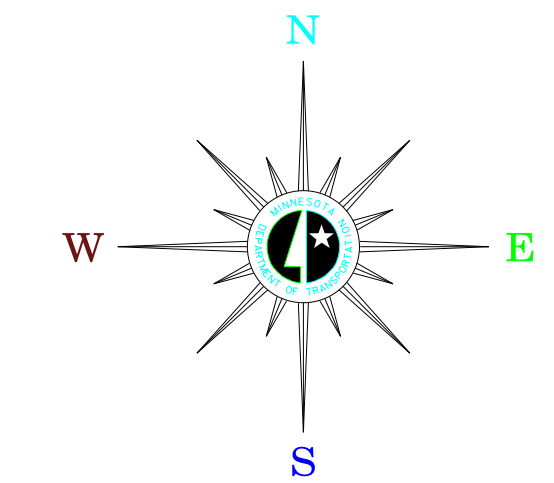

LEGEND

- INTERSTATE TRUNK HIGHWAY..... (35)
- U.S. TRUNK HIGHWAY..... (10)
- STATE TRUNK HIGHWAY..... (55)
- COUNTY STATE AID HIGHWAY..... (23)
- COUNTY ROAD..... (3)
- CORPORATE LIMITS.....
- PUBLIC ROAD.....
- PRIVATE ROAD.....
- COUNTY STATE AID HIGHWAY IN ADJOINING COUNTY..... (21)

1. PRAIRIE CREEK LN.
2. PRAIRIE CREEK CIR.
3. PARKINGTON AVE. N.E.
4. RACHELLE ST.
5. MANCHESTER AVE.
6. MACLAREN AVE.
7. 65TH CIR.
8. MANCHESTER WAY

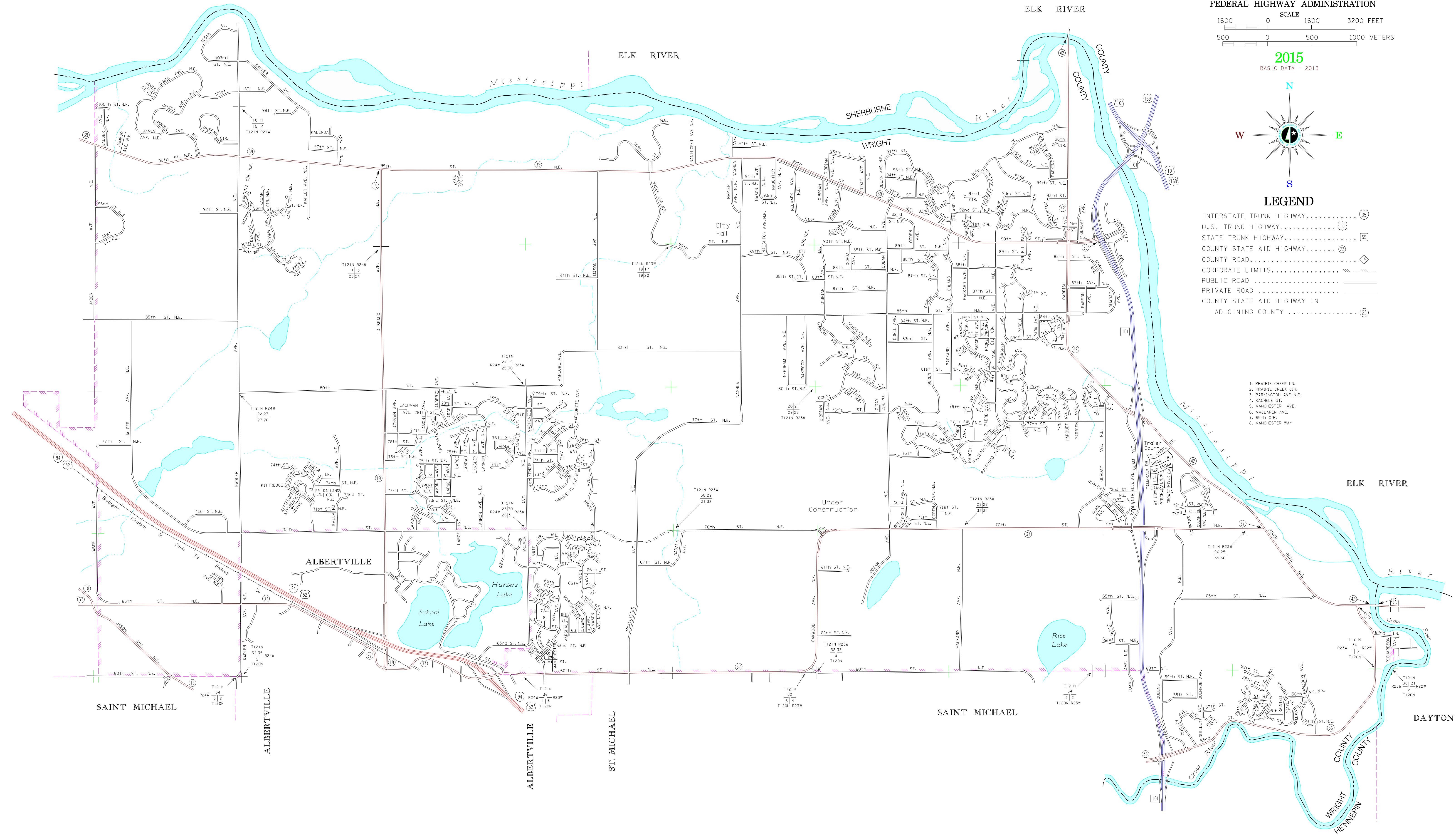

To request information from this document in an alternative format, call 800-368-4718 or 1-800-657-3774 (Greater Minnesota), 711 or 1-800-627-3529 (Minnesota Relay). You may also send an e-mail to ADArequest.do@state.mn.us. (Please request at least one week in advance.)