

# TOWNSHIP OF GREENBUSH

PREPARED BY THE  
MINNESOTA DEPARTMENT OF TRANSPORTATION  
OFFICE OF TRANSPORTATION SYSTEM MANAGEMENT

IN COOPERATION WITH  
U.S. DEPARTMENT OF TRANSPORTATION  
FEDERAL HIGHWAY ADMINISTRATION

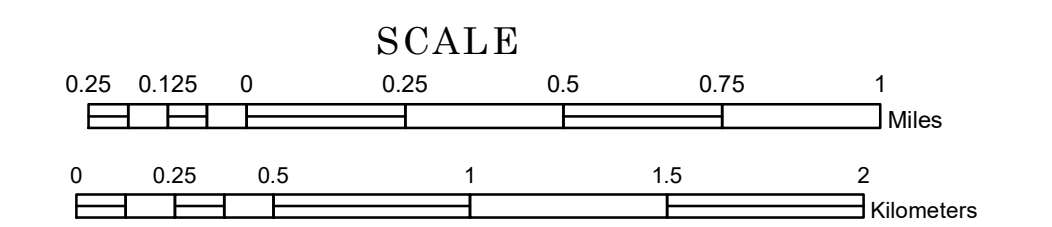

1 in = 1,600 ft

2023

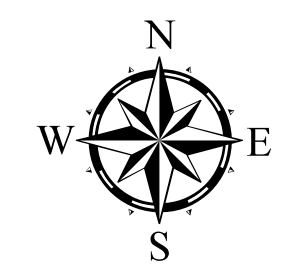

Projection:  
Transverse Mercator  
NAD 1986  
UTM Zone 15

North American Datum  
of 1986

ROAD AND ROADWAY FEATURES		BOUNDARY FEATURES	
INTERSTATE	CONCRETE	TRIAL LAND	TRIBAL LAND
US HIGHWAY	BITUMINOUS	STATE OF MINNESOTA	COUNTY
MN HIGHWAY	GRAVEL	MUNICIPALITY	UNORGANIZED TERRITORY
COUNTY STATE AID HIGHWAY	DIRT/UNIMPROVED	UNORGANIZED TERRITORY (2014)	CIVIL TOWNSHIP
COUNTY ROAD	OTHER	FEDERAL ADJUSTED URBAN AREA (2014)	CONGRESSIONAL TOWNSHIP
TOWNSHIP ROAD	UNKNOWN	CIVIL TOWNSHIP	SECTION
UNORGANIZED TERRITORY ROAD		CONGRESSIONAL TOWNSHIP	MILITARY
OTHER ROADS		SECTION	VOYAGEURS NATIONAL PARK
Municipal	RAMP OR CONNECTOR	MILITARY	BOUNDARY WATERS CANOE AREA WILDERNESS
Private	INTERSTATE EXIT	VOYAGEURS NATIONAL PARK	STATE PARK
National Monument	INTERSTATE EXIT	STATE PARK	NATIONAL FOREST
National Park	AVIATION FEATURES	NATIONAL FOREST	NATIONAL AND STATE FOREST
National Wildlife Refuge	COMMERCIAL AIRPORT	NATIONAL AND STATE FOREST	STATE FOREST
State Park	GENERAL AIRPORT	STATE FOREST	WILDLIFE REFUGE AREA
Preserve	AIRSTRIP	WILDLIFE REFUGE AREA	WILDLIFE MANAGEMENT AREA
	SEAPLANE	WILDLIFE MANAGEMENT AREA	HYDROLOGIC FEATURES
	AIRPORT RUNWAY	HYDROLOGIC FEATURES	RIVER OR STREAM (PERMANENT)
		RIVER OR STREAM (PERMANENT)	LAKE, POND OR RESERVOIR
		LAKE, POND OR RESERVOIR	STREAM (INTERMITTENT)
		STREAM (INTERMITTENT)	DRAINAGE DITCH
		DRAINAGE DITCH	WETLAND
		WETLAND	ISLAND OR LAND
		ISLAND OR LAND	REGIONAL WATERSHED
		REGIONAL WATERSHED	

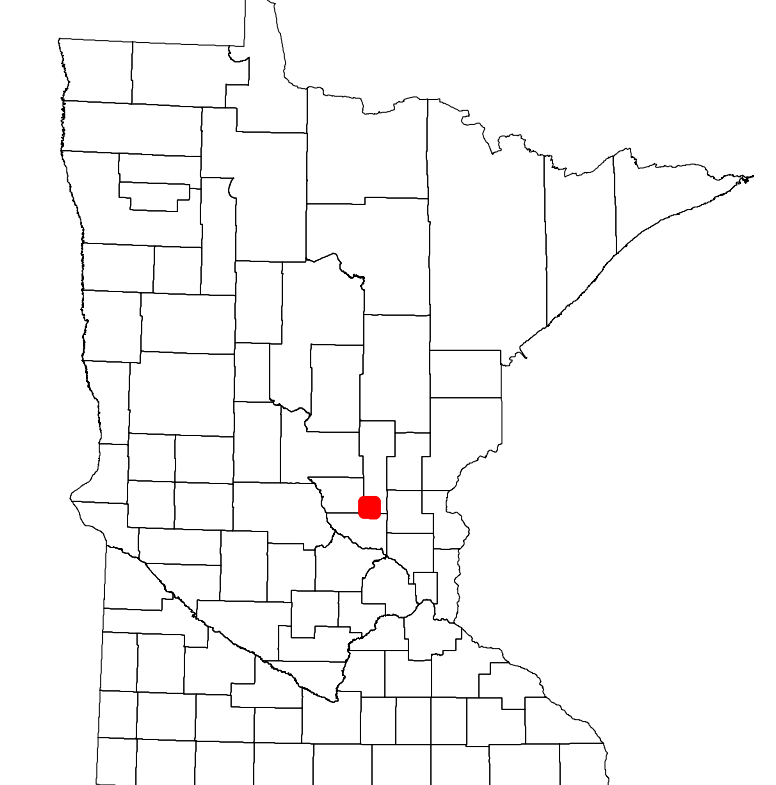

Population (U.S. Census 2010): 1293

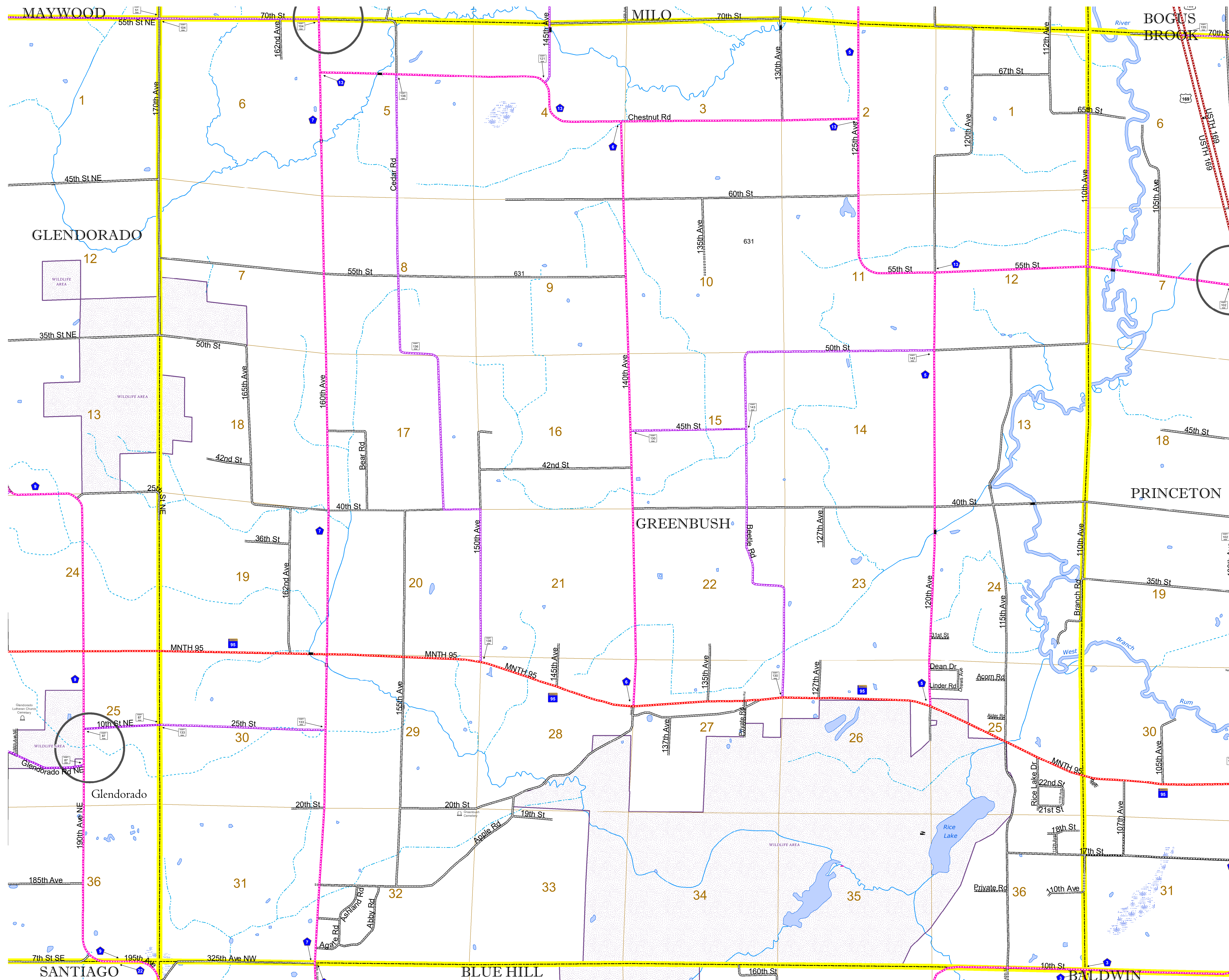

To request information from this document in an alternative format, call 651-366-4718 or 1-800-657-3774 (Greater Minnesota); 711 or 1-800-627-3529 (Minnesota Relay). You may also send an e-mail to ADRequest.dot@state.mn.us. (Please request at least one week in advance.)