

REVISION DATE 02/26/20

26-FEB-2020

### Sample Plan

#### TEMPORARY CONSTRUCTION PLAN ----- NARRATIVE

##### References:

Design Scene: Chapter 6 - Staging and Bypasses

##### General Information:

Meet with Traffic, Construction, Water Resources, Materials and Maintenance to review the bypass and/or cross-over concept and incorporate their comments for items such as temporary lighting, temporary signals, recommended design speeds, portable changeable message boards, pavements, drainage, Temporary Pedestrian Access Route, etc. into the temporary construction plan.

Work with the area Business Liaison and Area Manager to honor all commitments made to affected groups (municipalities, citizens, etc.). For example, consider accesses that need to be kept open, temporary right or left turn lanes, etc.

Determine the number of traffic lanes and lane widths. Consider if temporary concrete median barrier or impact attenuators are needed. (It may affect the bypass, cross-over and/or shoulder widths).

Bypasses and cross-overs should be evaluated for safety performance using the 10 critical design elements available at <http://www.dot.state.mn.us/planning/hpdp/>. Consult with GDSU (Geometric Design Unit) to insure bypasses and cross-overs are safe for the traveling public.

If temporary drainage is required, obtain recommendations from Water Resources Engineering.

For each bypass and cross-over alignment, the quantities should be identified separately in all tabulations.

Account for temporary construction removal or salvage quantities.

Consider the availability of earthwork quantities from within the project limits during each stage of construction.

Consider erosion control and turf establishment measures required for temporary construction.

Show all utilities within the temporary construction area.

### Sample Plan

#### TEMPORARY CONSTRUCTION PLAN ----- CHECKLIST

- \_\_\_ 1. Utilities Relocation
- \_\_\_ 2. Impact Attenuators, traffic barriers
- \_\_\_ 3. Pedestrian Crossings
- \_\_\_ 4. Legend
- \_\_\_ 5. North Arrow
- \_\_\_ 6. Scale
- \_\_\_ 7. Label Cross-over and Bypass Alignments
- \_\_\_ 8. Temporary drainage, superelevations, lighting, signing, turf establishment, etc.
- \_\_\_ 9. Cross references to other sheets (as applicable)
- \_\_\_ 10. Drawn by: and Checked by: Initials and Engineer's signature

PLOTTED/REVISED: 26-FEB-2020

DISTRICT #: Metro  
PLOT NAME: bypplan  
FILENAME: Projects\DM\_RCS\Won\_Proj\Project\Design\SamplePlan\English\bypplan.dgn

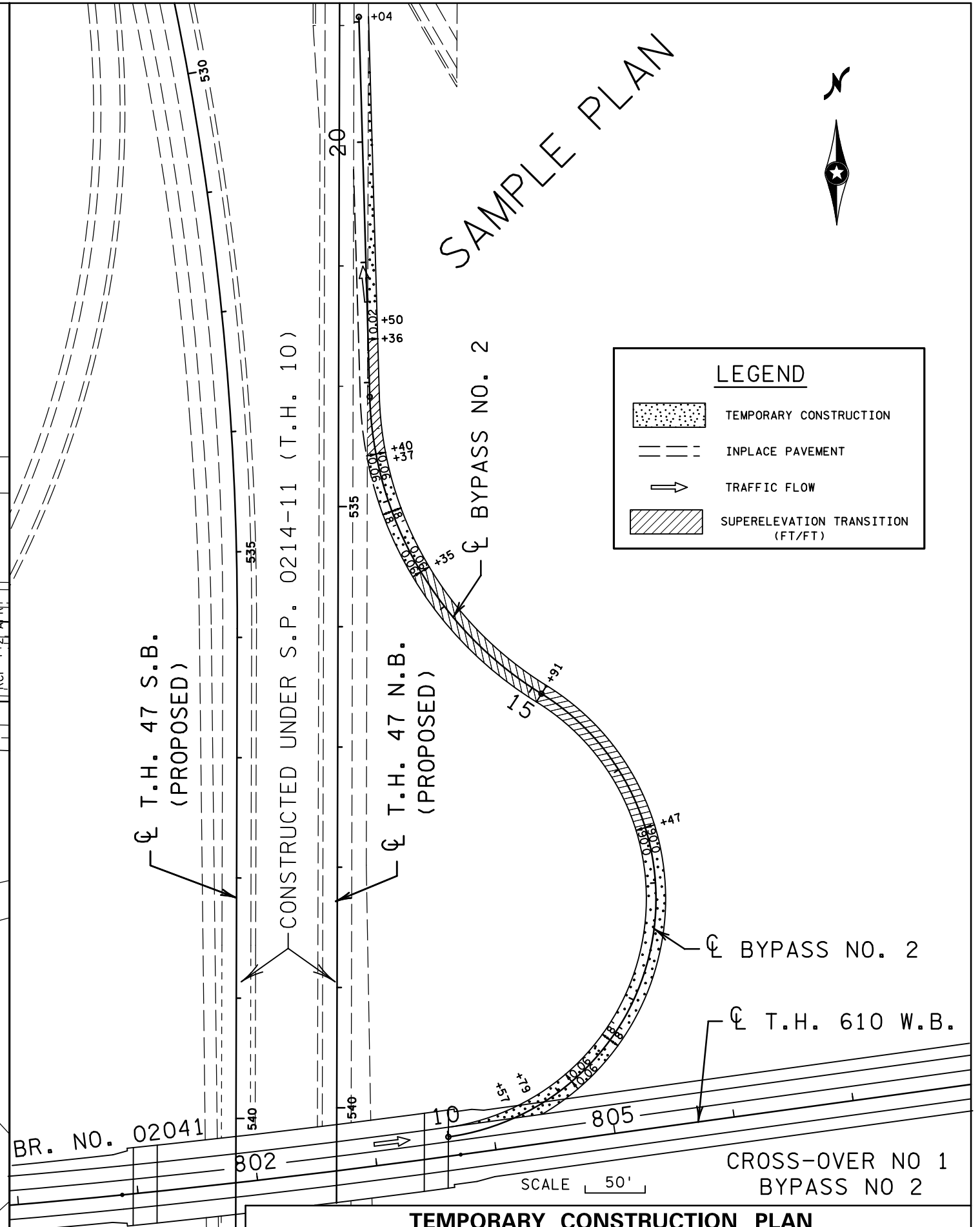
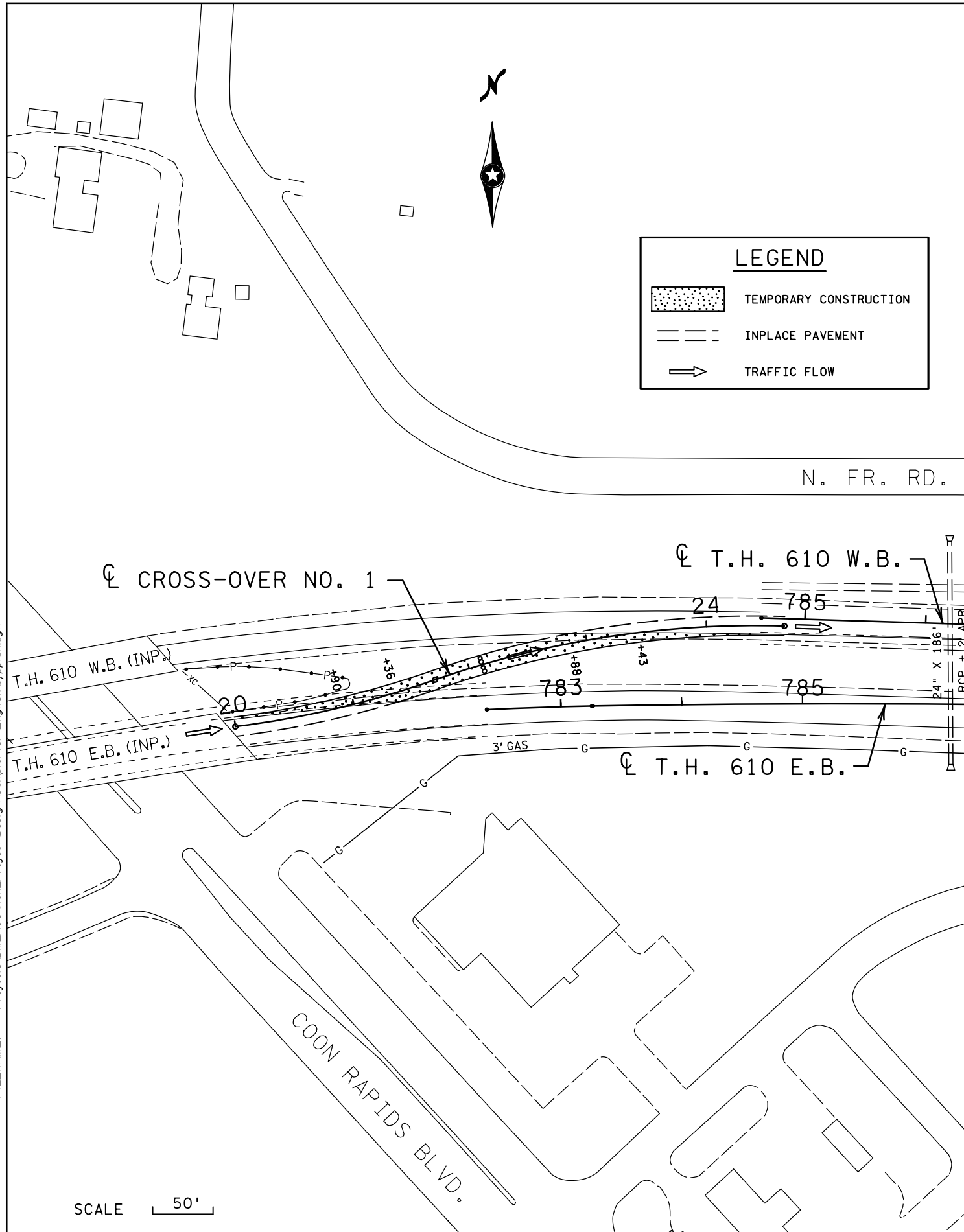

SAMPLE PLAN

TEMPORARY CONSTRUCTION PLAN