

## Sample Plan

## INPLACE TOPOGRAPHY ----- NARRATIVE

## References:

Design Scene:	Chapter 8 - Inplace Topography and Removals
Technical Manual:	5-292.620 Symbols Used In Highway Drawings

## General Information:

All existing features should be shown. This includes items such as roadways, curbs, trails, buildings, fence, guardrail, trees, ponds, wetlands, right of way, noxious weeds, etc.

Removal, salvage, and clearing and grubbing items should be shown and labeled. If not too cluttered, combine Inplace Topography plan sheets with Removals and Inplace Utilities. If the Inplace Topography sheets appear cluttered, consider showing the clearing & grubbing, the removal & salvage, the drainage features and/or the Inplace utilities in their own separate portion(s) of the plan.

All existing roadways should be shown in a dash format or a lighter weight and labeled.

Show all building structure types and addresses if possible. Include the name of all commercial buildings.

Label concrete and bituminous surfaces.

Include proposed Right of Way and Easements. Do not label dimensions.

All proposed construction may be shown by using a pattern format and noted on each sheet, unless the sheet becomes too cluttered by doing so.

Identify the alignment of all proposed roadways and retaining or noise walls.

Identify or cross-reference areas of environmental sensitivity.

Pattern buildings to be removed, if not shown elsewhere. When a specific Right of Way parcel includes more than one building to be removed, pay for the removal by the parcel and not the individual buildings.

Use computer files and as-built plans to obtain the best topographic information. When office topography plan sheets are completed, field review project to make sure the information shown is accurate and complete.

Plan sheet location index box should be considered on projects with complicated plan sheet layouts.

It is recommended that construction limits be shown on the Inplace Topography Plans, unless the plan sheets would become too cluttered.

## Sample Plan

## INPLACE TOPOGRAPHY ----- CHECKLIST

- \_\_\_ 1. North arrow
- \_\_\_ 2. Bar Scale
- \_\_\_ 3. Inplace and proposed Right of Way and Easements
- \_\_\_ 4. Bridges labeled
- \_\_\_ 5. Proposed construction stationing shown at 500 ft. intervals
- \_\_\_ 6. Existing features labeled
- \_\_\_ 7. Identify and label existing utilities if included in this plan set
- \_\_\_ 8. Removal and Salvage items
- \_\_\_ 9. Cross references to other sheets (as applicable)
- \_\_\_ 10. Drawn by: and Checked by: Initials and Engineer's signature

REVISION DATE 02/22/16  
PLOTTED/REVISED: 26-JAN-2017 08:29

DISTRICT #: METRO  
PLOT NAME: sp1nptopog  
FILENAME: Projects\DM\_ROMS\Non\_Project\Design\SamplePlan\Eng\Tsh\Inptopog.dgn

NOTE: FOR INPLACE UTILITIES AND DRAINAGE  
SEE INPLACE UTILITIES PLAN SHEETS.

SAMPLE PLAN

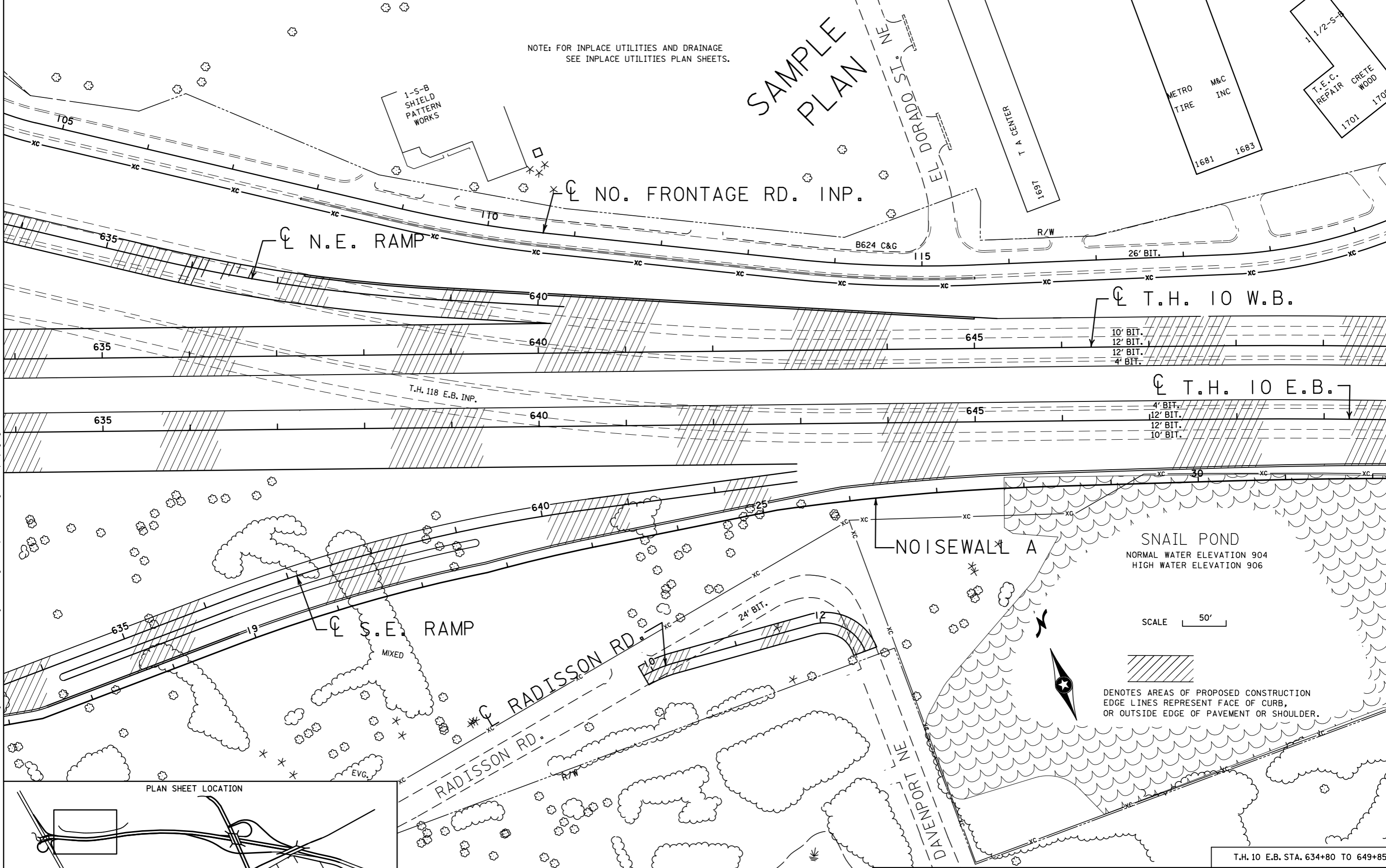

1-S-B SHIELD PATTERN WORKS

METRO TIRE 1681  
M&C INC 1683

T.E.C. REPAIR 1701  
CRETE WOOD 1705

10' BIT.  
12' BIT.  
12' BIT.  
4' BIT.

4' BIT.  
12' BIT.  
12' BIT.  
10' BIT.

NOISEWALL A  
SNAIL POND  
NORMAL WATER ELEVATION 904  
HIGH WATER ELEVATION 906

SCALE 50'

DENOTES AREAS OF PROPOSED CONSTRUCTION  
EDGE LINES REPRESENT FACE OF CURB,  
OR OUTSIDE EDGE OF PAVEMENT OR SHOULDER.

PLAN SHEET LOCATION

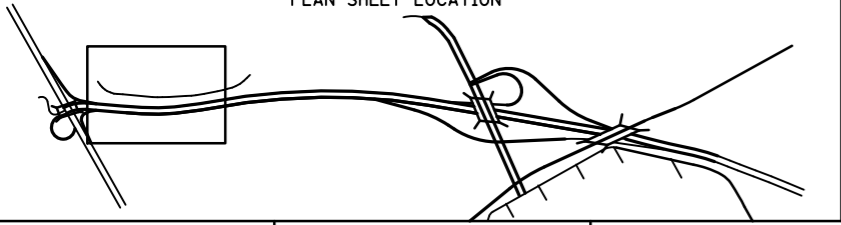

T.H. 10 E.B. STA. 634+80 TO 649+85

**INPLACE TOPOGRAPHY**