

PREPARED BY
HIGHWAY PLANNING SURVEY
IN COOPERATION WITH
U. S. PUBLIC ROADS ADMINISTRATION

STATE OF MINNESOTA
DEPARTMENT OF HIGHWAYS
ROAD LIFE STUDIES
CONSTRUCTION PROJECT LOG RECORD

CONTROL SECTION 1903
TRUNK HIGHWAY 20
COUNTY Dakota
DISTRICT Metro

LIMITS: South Co. Line - Jct. T.H. 61

Ref. Pt. 003+00.082 - 007+00.488

PLAN

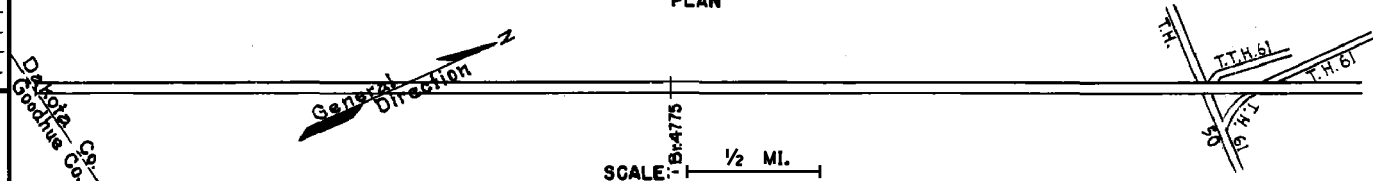

YEAR BUILT	PROJECT N°	DESCRIPTION			CODE N°
		TYPE	WIDTH	THICKNESS	
		Gravel Br.M-1300	24' 18'	2" 12" B.S.	No Record of Constr.
1930	20-20-27	Grading	32'		
1931	20-20-27B	Grading Br.4775	40'		Y106D.
1931	20-20-27B	Concrete	20'	8-79	
M	1954 A.F.E. 821	Drainage Correction			
C	1967 1903-02	Pt. Mix. Bit. Surf On P.C. Conc. in place Gravel. Shldr.	20'	2 1/2"	8' Rt. & Lt.
C	1984 1913-44	Grading, Base Bit. Surfacing Bit. Shoulders			
C	1989 1903-05	Bit. Overlay Turn Lane	26'	1 1/2"	Spec. 2331 Spec. 2341
S	2005 1903-06	Milling & Grading Bit. Surfacing	24'	2"	Spec. 2360
S	2008 8825-274	Bituminous Route & Seal			Spec. 2331
	2010 1903-08	Micro Surfacing Seal Coat			

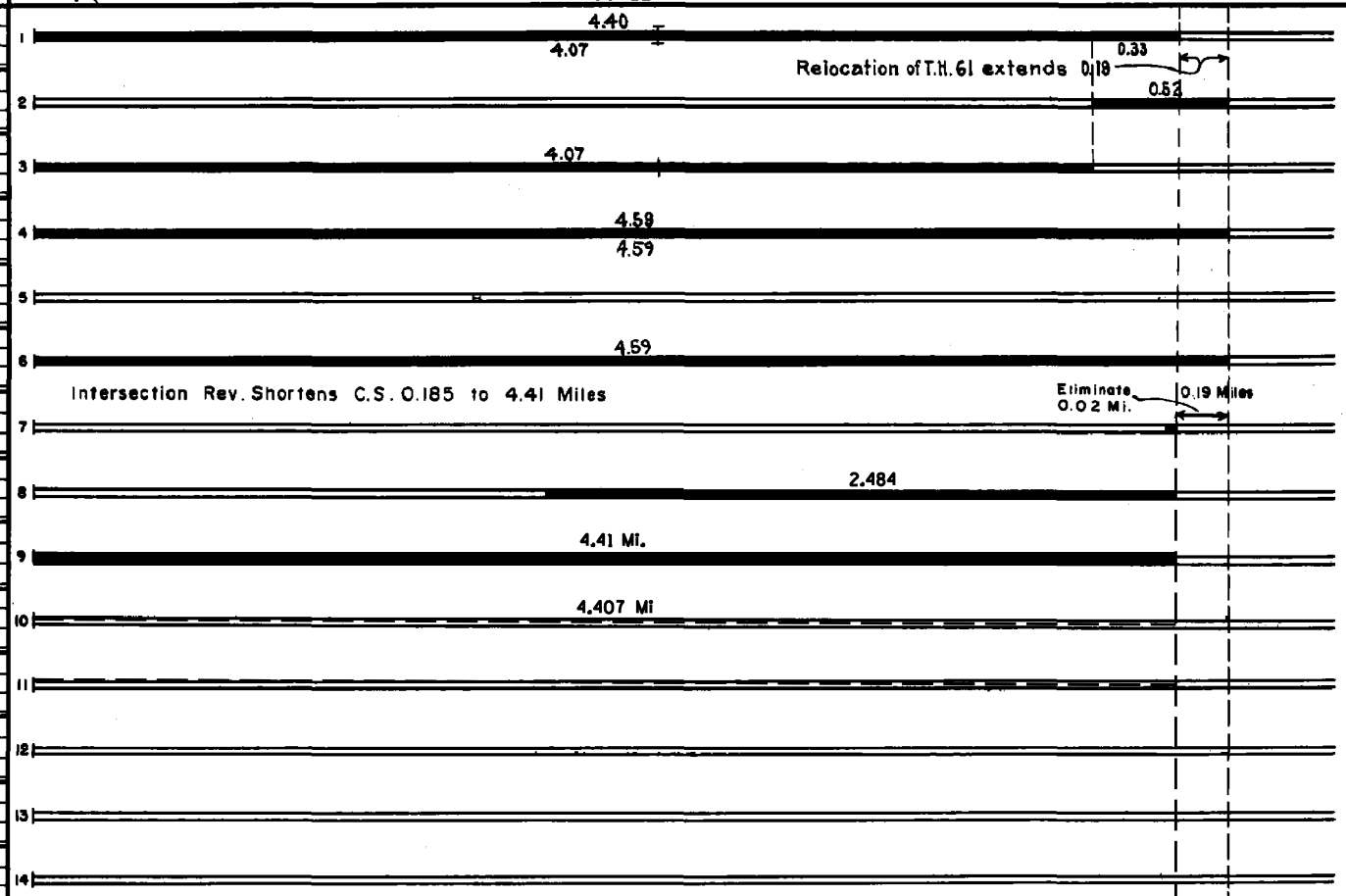

YEARS FROM	YEARS TO	TOTAL MILES	UNINCORPORATED		INCORPORATED		RURAL		URBAN	
			RDWY. MI.	BR. MI.	RDWY. MI.	BR. MI.	RDWY. MI.	BR. MI.	RDWY. MI.	BR. MI.
1921	1929	4.40	4.35	0.01	0.00	0.00	4.35	0.01	0.00	0.00
1930	1930	4.59	4.58	0.01	0.00	0.00	4.58	0.01	0.00	0.00
1931		4.59	4.59	0.00	0.00	0.00	4.59	0.00	0.00	0.00

REMARKS: Layout is to scale as of 1930