

PREPARED BY
HIGHWAY PLANNING SURVEY
IN COOPERATION WITH
U.S. PUBLIC ROADS ADMINISTRATION

STATE OF MINNESOTA
DEPARTMENT OF HIGHWAYS
ROAD LIFE STUDIES
CONSTRUCTION PROJECT LOG RECORD

CONTROL SECTION 2508
TRUNK HIGHWAY 56
COUNTY Goodhue
DISTRICT 68

LIMITS: N. Jct. T.H. 60 in Canyon - N. End of Bridge (Cannon River)

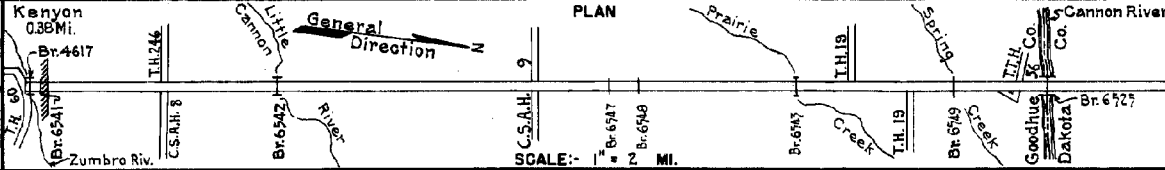

YEAR BUILT	PROJECT N ^o	DESCRIPTION			CODE N ^o
		TYPE	WIDTH	THICKNESS	
		Gravel	20'	2"	No Record of Constr. Added in 1934.
		Br. 6153 & 2856	21-17'		28' C.S. & 28' B.S.
		Gravel	24'	1 1/2"	No Record of Constr. Added in 1934.
		Br. X-657	14'		24.8' Stone Arch.
1927		Br. 4617	23'		30' C.D.G.
1928		Grading	24'	3/4"	Co. Job 2803 Added in 1934. 1600 C.Y./Mi.
		Gravel	24'	3/4"	W108 D & 160' H.T.
		Br. 6154 & 6155	15'		
1935		Br. 4505	23'		12' s.s. Maint. Dept.
1935		Br. 1452	24'		34' D.P.G. Maint. Dept.
M	1940 A.F.E. 44	Spot Graveling			124 C.Y./Mi. Maint. Dept.
M	1942 A.F.E. 6	Spot Graveling			200 C.Y./Mi. Maint. Dept.
M	1943 A.F.E. 6	Grav. Resurfacing (Spots)			137 C.Y./Mi. Maint. Dept.
M	1944 A.F.E. 6	Grav. Resurfacing (Spots)			301 C.Y./Mi. Maint. Div.
M	1945 A.F.E. 6	Grav. Resurfacing (Spots)			98 C.Y./Mi. Maint. Div.
C	1947 2508-03	Grading	36'		
(D)		Stab. Gravel	30'	2"	1200 C.Y./Mi.
C	1948 2508-10	Grading			
(D)		Gravel Base	32'	18"	
C	1948 A.F.E. 32	Bit Surfacing			603, 10013 Gal.
(D)		Bit Surf. treated	26'	3/4"	
		(Mixed Prime)			

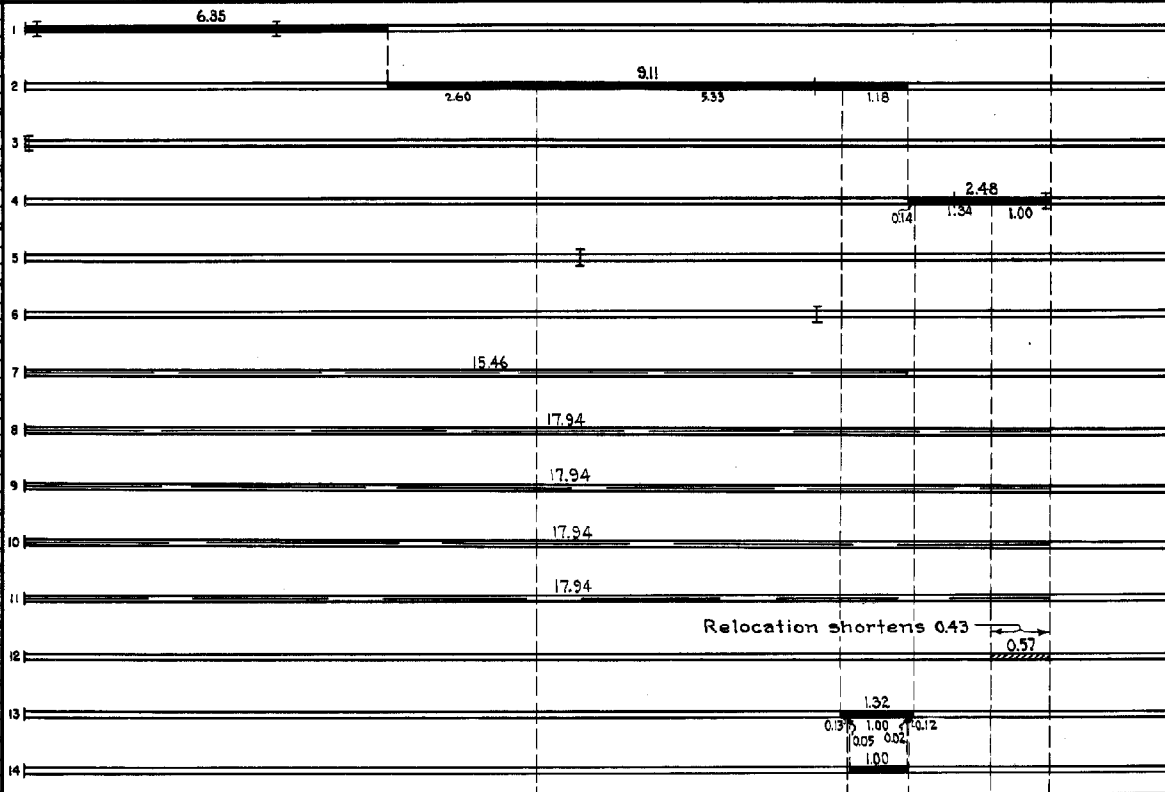

YEARS		TOTAL	UNINCORPORATED		INCORPORATED		RURAL		URBAN	
FROM	TO	MILES	RDWY. MI.	BR. MI.	RDWY. MI.	BR. MI.	RDWY. MI.	BR. MI.	RDWY. MI.	BR. MI.
1934	1934	17.94	17.52	0.03	0.38	0.01	17.52	0.03	0.38	0.01
1935	1946	17.94	17.51	0.04	0.36	0.01	17.51	0.04	0.36	0.01
1947	1948	17.51	17.06	0.06	0.36	0.01	17.06	0.06	0.36	0.01
1949	1949	17.49	17.05	0.05	0.38	0.01	17.05	0.05	0.38	0.01
1950	1968	17.17	16.72	0.06	0.39	0.01	16.72	0.06	0.39	0.01
1969		17.15	16.71	0.06	0.37	0.01	16.71	0.06	0.37	0.01

REMARKS: Layout is to scale as of 1934
(D) Old road in use until new Cannon River bridge is built.

PREPARED BY
HIGHWAY PLANNING SURVEY
IN COOPERATION WITH
U. S. PUBLIC ROADS ADMINISTRATION

STATE OF MINNESOTA
DEPARTMENT OF HIGHWAYS
ROAD LIFE STUDIES
CONSTRUCTION PROJECT LOG RECORD

CONTROL SECTION 2508
TRUNK HIGHWAY 56
COUNTY Goodhue
DISTRICT 68

LIMITS: N.Jct.T.H.60 in Kenyon - N End of Bridge (Cannon River)

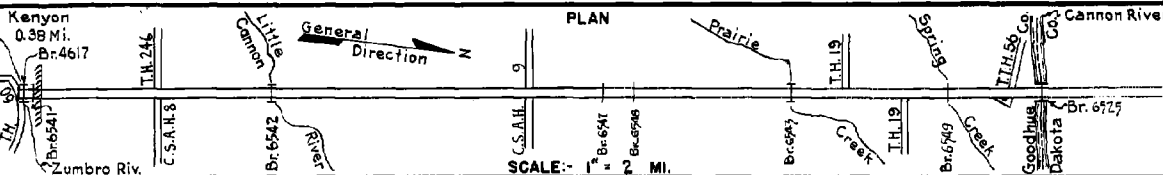

YEAR BUILT	PROJECT N ^o	DESCRIPTION			CODE N ^o
		TYPE	WIDTH	THICKNESS	
M	1948 A.F.E. 6	Grav. Resurfacing			5350 Tons
C	1948 A.F.E. 7	Seeding			
C	1949 2508-12	Plant Mix Bit.	24'	1 1/2" added	
C	1949 2508-02	Grading	38 3/8'		10' Select Material
(1)	2508-07A-09	Stab. Gravel	24'	2 1/2"	1200 C.Y./Mi.
		Bridges & Culv. (2)			
C	2508-11	Grading	76'		10' Select Material
1970	2508-08	Gravel	76'		700 C.Y./Mi.
	2508-07	Bridges & Culv. (3)			
C	1970 A.F.E. 23	Bit. Surfacing	24'	1 1/2"	M63, 29502 Gal. Agg. 1587 C.Y.
		Mixed Bit. (Mixed Prime 1.51 Mi.)			
C	1951 A.F.E. 20	Const. Ditch Block			42x44' Metal Arch
		Install Culvert			
C	1952 2508-14	Gravel Base	32'	0'-9"	
		Plant Mix Bit.	24'	1 1/2"	
M	1952 A.F.E. 5	Light Bit. Seal	24'		RS-2, 2189 Gal. Agg. 72 C.Y.
M	1955 A.F.E. 820	Base Repair			MC-2, 782 Gal. Plant Mix 543 Tons
		Spot Treat.			
		Bit. Surf. Repair	24'		Subgr. Corrections
M	1956 A.F.E. 605	Light Bit. Seal	24'		RS-2, 28705 Gal. Agg. 1080 C.Y.
M	1959 A.F.E. 605	Light Bit. Seal	25'		RS-2, 5532 Gal. Agg. 196 C.Y.
M	1960	Spot Treat			
		Bit. Surf. Repair	24'		Plant Mix 296 Tons
M	1961	Light Bit. Seal	25'		RS-2, 25908 Gal. Agg. 850 C.Y.

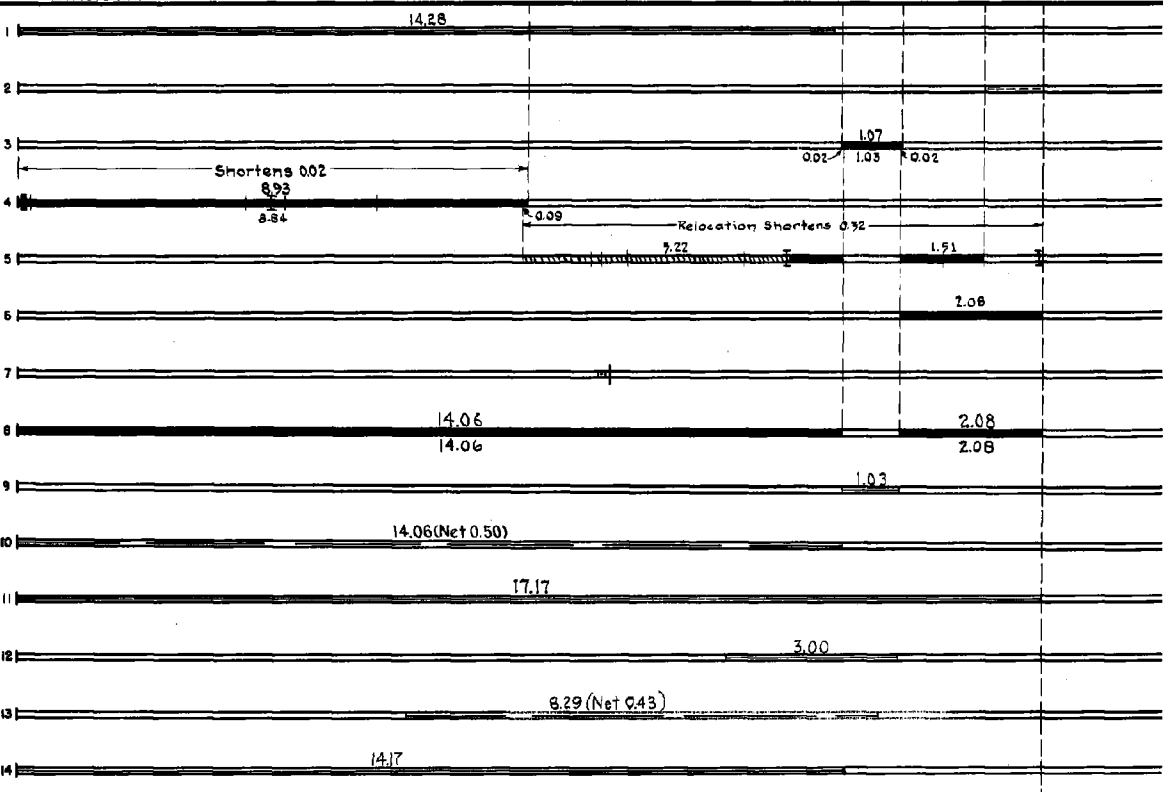

YEARS		TOTAL MILES	UNINCORPORATED		INCORPORATED		RURAL		URBAN	
FROM	TO		RDWY. MI.	BR. MI.	RDWY. MI.	BR. MI.	RDWY. MI.	BR. MI.	RDWY. MI.	BR. MI.

REMARKS: See Sheet No. 1
(1) Contract not final but work substantially complete in 1949. (2) Br. 4617, 30' C.D.G. widened to 32'; Br. 6541, C101-14-108T; C55; Br. 6542, 40'x30' C.D.G.; Br. 6548, C1010H; Br. 8664, C108.
(3) Br. 8663, C108; Br. 6747, C108 D; Br. 6748, C108 D; Br. 8666, C108; Br. 6745, 20' C.D.G.; Br. 6549, C128 D; Br. 6725, 22' Cent. L. Beam & 6 sectional Cattle Passes.

PREPARED BY
TRAFFIC AND PLANNING DIVISION
IN COOPERATION WITH
U.S. DEPARTMENT OF COMMERCE
BUREAU OF PUBLIC ROADS

STATE OF MINNESOTA
DEPARTMENT OF HIGHWAYS
ROAD LIFE STUDIES
CONSTRUCTION PROJECT LOG RECORD

CONTROL SECTION 2508
TRUNK HIGHWAY 56
COUNTY Goodhue
DISTRICT 6B

LIMITS: N. Jct. T.H. 60 in Kenyon - N. end of Bridge (Cannon River)
Ref. Pt. 075+00.476 - 092+00.632

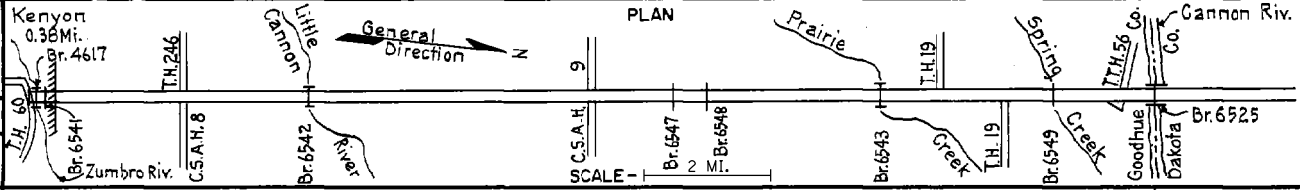

YEAR BUILT	PROJECT NO	DESCRIPTION			
		TYPE	WIDTH	THICKNESS	REMARKS
M 1962		Bit Surf. Repair	24'		Rd. Mix. 353 Tons MC-2, 355 Gal.
C&M 1965	C 2508-16	Light Bit. Seal Erosion Control	25'		RS-10, 30122 Gal. Agg. 1055 C.Y. at Br. 6525
C 1967	2508-17	Pl. Mix. Bit Surf.	24'	3"	Mi. Pt. 000 to 003 & 8.67 to 8.92 regraded
M 1977	SF	SEAL COAT BRIDGES 4617, 6542, 6543 & 6525 WITH PEA AGG.	30'-32'		CRS-2 SEAL 700 GAL PEA AGG. 1/4 TON
M 1980	SF	Regravel Shoulders (Spot)	8'	Var.	4,564 Ton
M 1980	SF	Seal Coat Bridge Decks	30-32'		38 Ton Pea Rock 775 Gal. CRS 2 6525, 6545, 4817, 6542
M 1981	SF	Spot Regravel Shoulders	10'	Var.	742 Ton
M 1981	SF	Spot Bit Overlay Sage	24'	Var.	93 Ton 100 Gal. CSSIM Tank Pl. Mix. 2331 Fines
M 1983	SF	Spot Bit Overlay	24'	1 1/2"	Pl. Mix 2331, 71 Ton
M 1987	SF	Gravel Shouldering	8'	1 1/2"	
M 1987	SF	Spot Overlay	24'	1 1/2"	Spec. 2341
M 1987	SF	Spot Overlay	24'	3/4"	Spec. 2331
M 1987	SF	Spot Overlay		1 1/2"	Spec. 2331
C 1987	2508-20	Gravel Shouldering	8'	2"	

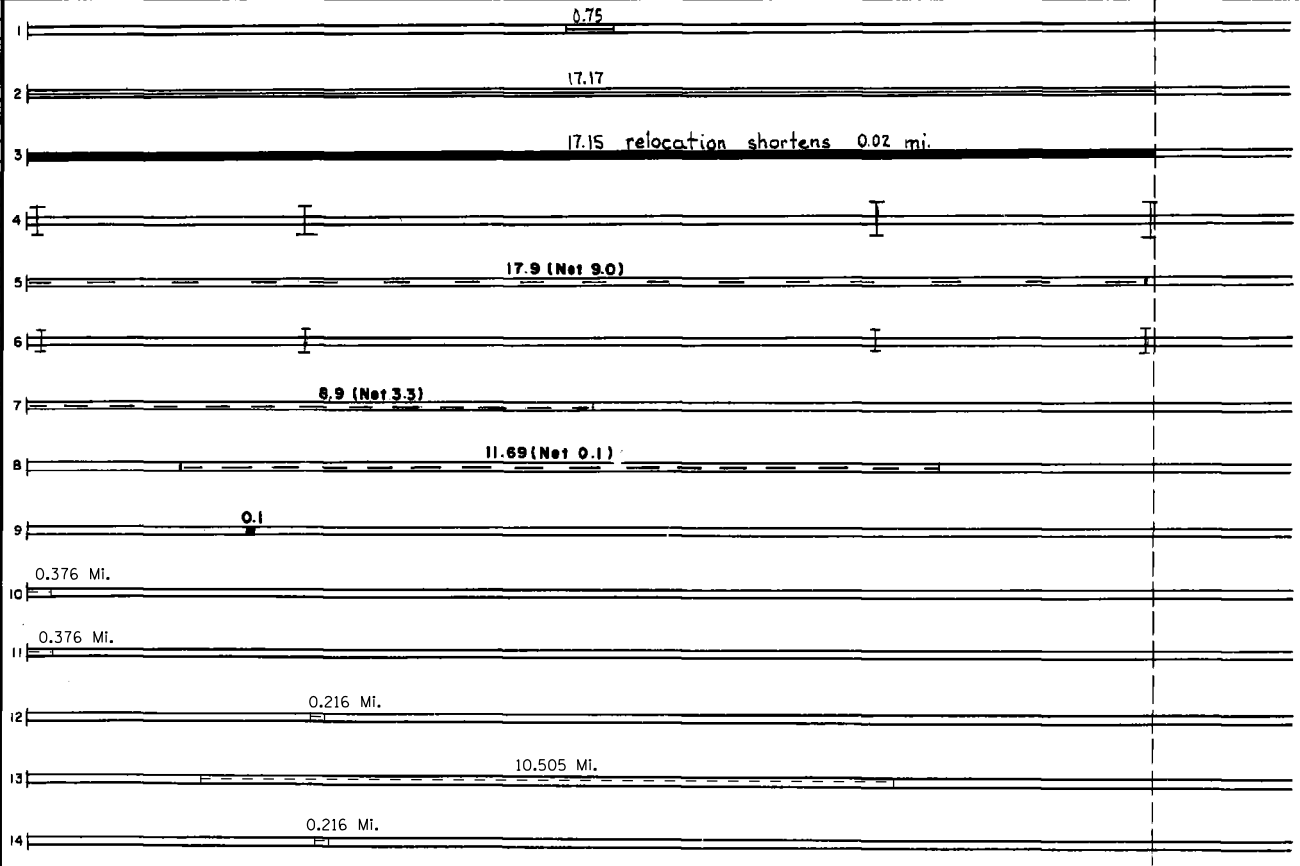

YEARS		TOTAL MILES	UNINCORPORATED		INCORPORATED		RURAL		URBAN	
FROM	TO		RDWY. MI.	BR. MI.	RDWY. MI.	BR. MI.	RDWY. MI.	BR. MI.	RDWY. MI.	BR. MI.

REMARKS: See Sheet No. 1

