

PREPARED BY  
HIGHWAY PLANNING SURVEY  
IN COOPERATION WITH  
U.S. PUBLIC ROADS ADMINISTRATION

STATE OF MINNESOTA  
DEPARTMENT OF HIGHWAYS  
ROAD LIFE STUDIES  
CONSTRUCTION PROJECT LOG RECORD

CONTROL SECTION 2734  
TRUNK HIGHWAY 100  
COUNTY Hennepin  
DISTRICT 5A

LIMITS: S. Jct. T.H. 169 in Edina - N. Jct. T.H. 169 in St. Louis Park

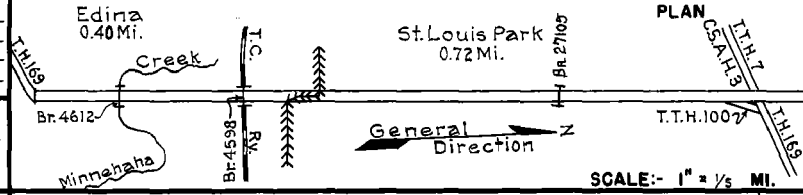

YEAR BUILT	PROJECT N°	DESCRIPTION			CODE N°
		TYPE	WIDTH	THICKNESS	
1926	100-5-31-3	Grading	60'		
					Not used as T.H. until 1927.
1927	100-5-31-3	Grading	60'		
		Br. 4612 & 4598	40'		30' C.D.G. & 105' C.D.G. O.H.
1928	100-5-31-3	Concrete	40'		
1938	2735-02	Grading Gravel	60'	12"	N.R.Y.R. 27-1. Divided Highway.
1938	A.F.E. 24	Mixed Bitum.	60'	2"	Divided Highway. Maint. Dept.
M					303,741.2 Gal.
1946	A.F.E. 4	Bit. Surf. Repair	60'		Agg. 320 C.Y.
C					
1949	2734-02	Traffic Signals			
C					
1950	2734-03	Traffic Signals			
C					
1952	2734-04	Asphaltic Conc.	40'	3"	On old P.C. Conc.
(1)					
M					Plant Mix 115 Tons
1952	A.F.E. 4	Spot Bit. Patching	37'		RC-2, 100 Gal.
M					RT-10, 230 Gal.
1954	A.F.E. 627	Bit. Seal Coat	40'		Agg. 18 C.Y.
C					
1964	By Maint. Div.	Deceleration Lanes			at S. Jct. T.H. 169
C					
1965	C	Spot Bit. Shoulders Plant Mix Bit.	Var. 40'		0'-10' Rt. & Lt.
					Maint. Contract
C					
1970	2734-15	Br. 27106 Br. 27105			Red. Br.

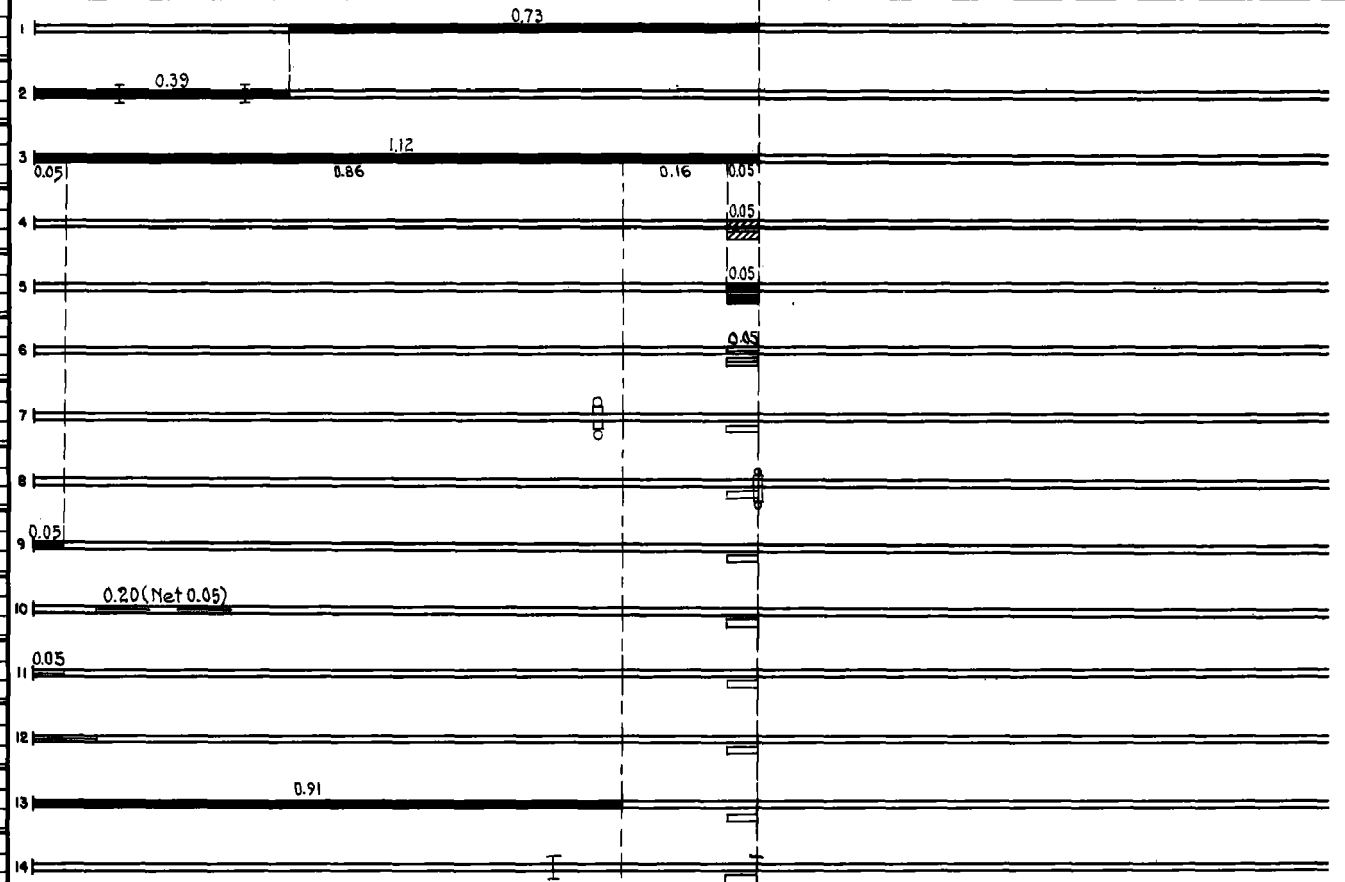

YEARS		TOTAL MILES	UNINCORPORATED		INCORPORATED		RURAL		URBAN	
FROM	TO		RDWY. MI.	BR. MI.	RDWY. MI.	BR. MI.	RDWY. MI.	BR. MI.	RDWY. MI.	BR. MI.
1927	1972	1.12	0.00	0.00	1.09	0.03	0.00	0.00	1.09	0.03
1975		1.24			1.21	0.03			1.21	0.03

REMARKS: Layout is to scale as of 1927  
(1) Contract not final but work substantially complete.

PREPARED BY  
TRANSPORTATION PLANNING AND PROGRAMMING DIVISION  
IN COOPERATION WITH  
U.S. DEPARTMENT OF TRANSPORTATION - FEDERAL HIGHWAY ADMINISTRATION

STATE OF MINNESOTA  
DEPARTMENT OF HIGHWAYS  
ROAD LIFE STUDIES  
CONSTRUCTION PROJECT LOG RECORD

CONTROL SECTION 2734  
TRUNK HIGHWAY 100  
COUNTY HENNEPIN  
DISTRICT Metro

LIMITS: Jct. of C.S.A.H. 158 IN EDINA ~ Jct. MNTH-7  
ST. LOUIS PARK  
Ref. Pt. 003+00.776 - 005+00.899

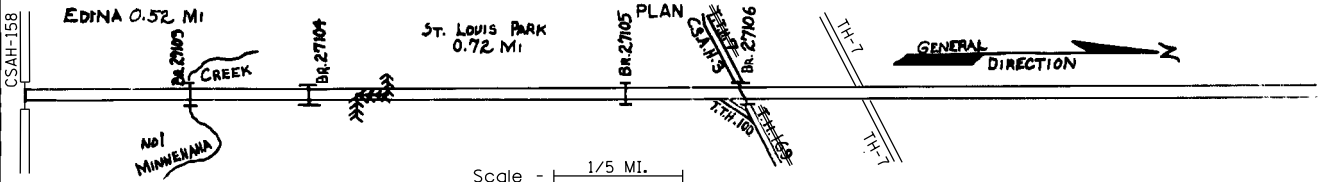

YEAR BUILT	PROJECT NO	DESCRIPTION				REMARKS
		TYPE	WIDTH	THICKNESS		
1970	2734-15	GRADING BASE				
	2734-19-20	P.C. CONCRETE LIGHTING & SIGNALS	20' 4"	9"		
1974	2734-18	GRAD. BASE, 4 CONC. SURF.	20' 3"	9"		DIVIDED HIGHWAY
	FOO5-2(4)	BR. 27103 BR. 27104				S.B.S. 55' - 0.H. S.A.S. 113' - 0.H.
1979	2734	Control Section Change				Effective Date: 02-02-1979
1981	2734 SF	Br. Repair Br. 27106				
1981	2734 SF	Br. Repair Br. 27103				
1984	2734	Pavement Joint and Crack Repair				Br. 27106
1985	2734-28	Grading, Agg. Base Concrete Surfacing Bit. Surfacing	36'	8" 10"		Spec 2331, 2361
1991	2734-34	Mill & Bit. Overlay	30'	3"		Spec 2331, 2361
2000	2733-77	Mill & Bit. Overlay R+ Shldr NB + SB Maj Conc. Pavmt Repair	10'	3"		Spec 2350
2005	2734-40	Grading Bit. & Conc. Surf. Bit. Mill & Overlay	var.	10" 2"		4 1/2" bit. recon. reinf. conc. 3' Agg. base
2006	2734-43	Grading Bit. Surfacing Mill & Bit. Overlay	var.	var. 4"		Spec. 2360
2009	8825-336	Rout & Seal				
2014	2734-33	Grading/Agg. Base Bit. Surfacing Br.'s 27303, 27304, 27305	126'	6" 8"		Class 6 Spec. 2360 Ramps
2015	2734-48	Bit. Mill & Overlay	var.	2"		Spec. 2360

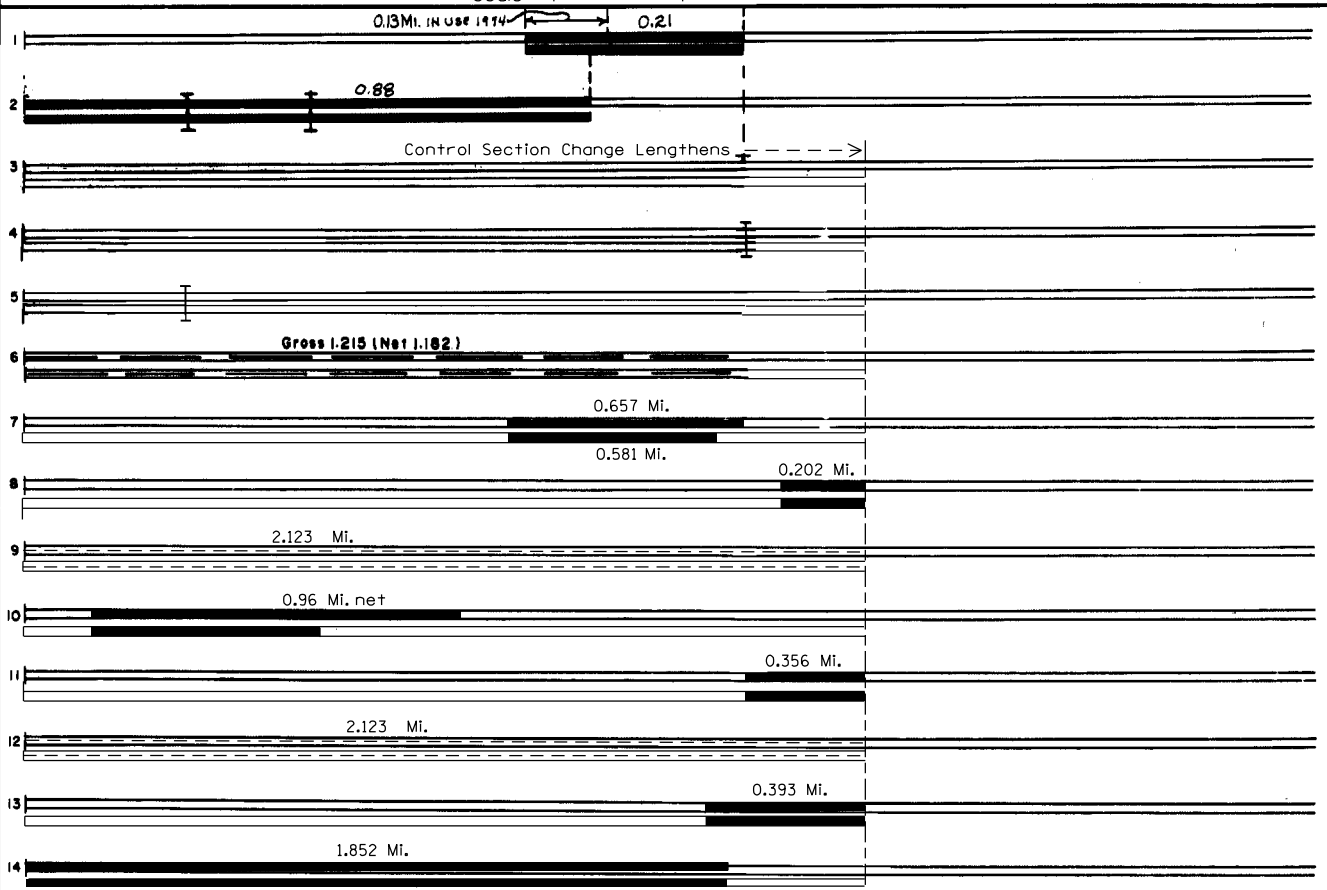

YEARS		TOTAL MILES	UNINCORPORATED		INCORPORATED		RURAL		URBAN	
FROM	TO		RDWY. MI.	BR. MI.	RDWY. MI.	BR. MI.	RDWY. MI.	BR. MI.	RDWY. MI.	BR. MI.

REMARKS: LAYOUT IS TO SCALE AS OF 1973