

PREPARED BY  
HIGHWAY PLANNING SURVEY  
IN COOPERATION WITH  
U. S. PUBLIC ROADS ADMINISTRATION

STATE OF MINNESOTA  
DEPARTMENT OF HIGHWAYS  
ROAD LIFE STUDIES  
CONSTRUCTION PROJECT LOG RECORD

CONTROL SECTION 2509  
TRUNK HIGHWAY 87  
COUNTY Hubbard  
DISTRICT 2A

LIMITS: Jct.T.H.71-Jct.T.H.64

YEAR BUILT	PROJECT N°	DESCRIPTION			CODE N°
		TYPE	WIDTH	THICKNESS	
		Gravel	24'	2"	No Record of Constr. Added in 1934.
		Br.X-288 & X-289	16'		566' L.T. & 60' L.T.
1936		Br.5726	24'		35' D.P.G.
		Br.5727	24'		35' D.P.G. Maint. Dept.
M					Clay 301 C.Y./Mi.
1942	A.F.E.6	Reshape, Clay Surf & Stab.	24'		Maint. Dept.
C		Bit Surfacing			Light Reshaping
1948	A.F.E. 24	Bit Surf. Treated (Mixed Prime)	24'	3/4"	MC3 & 5C3,503 1/4 Gal.
M					MC-3, 1000 Gal. Agg. 18 C.Y.
1949	A.F.E. 4	Fog Seal Coat (Spots)	24'		
C					
1949	A.F.E. 26	Reshaping	26'		
C		Grading	32'		10' Select Material
1949	2909-02	Stab. Gravel	24'	2 1/2"	1200 C.Y./Mile
		Br. 8712			C86=108'
C		Bit Surfacing			MC-3, 11260 Gal
1950	A.F.E. 17	Bit Surf. Treated (Mixed Prime)	28'	3/4"	
C		Bit Surfacing (6.05)			MG3 & 5C2, 10447 Gal.
1951	A.F.E. 38	Bit Resurfacing (4.20)			Agg. 5754 C.Y.
		Mixed Bit.	26'	1 1/4"	
M					MC2, 6290 Gal.
1952	A.F.E. 4	Bit Surf. Repair	24'		
C		Bit Surfacing			MC2, 105389 Gal.
1954	A.F.E. 818	Mixed Bit. (Mixed Prime)	27'	1 1/4"	Agg. 8358 Tons
M					RCS-2, 7764 Gal.
1955	A.F.E. 605	Light Bit Seal	26'		Agg. 250 C.Y.
M					RCS-2, 15040 Gal.
1956	A.F.E. 605	Light Bit Seal	24'		Agg. 536 C.Y.
M		Spot Treat			Bit. 26361 Gal.
1958	A.F.E. 604	Bit Surf. Repair	24'		Agg. 691 C.Y. & 228 Tons
		Light Bit Seal (0.25%)	27'		

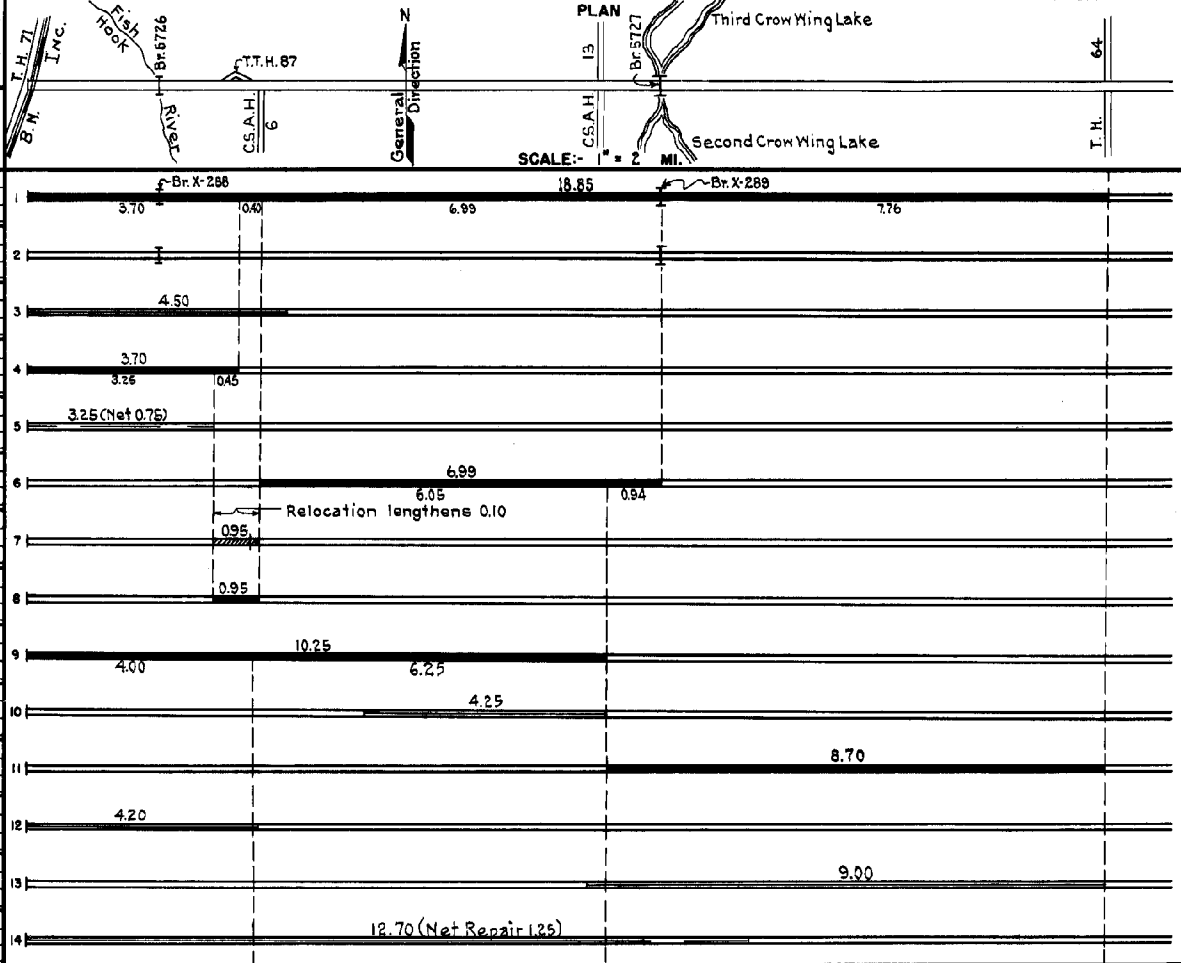

YEARS FROM	TO	TOTAL MILES	UNINCORPORATED		INCORPORATED		RURAL		URBAN	
			RDWY. MI.	BR. MI.	RDWY. MI.	BR. MI.	RDWY. MI.	BR. MI.	RDWY. MI.	BR. MI.
1934	1935	18.85	18.85	0.02	0.00	0.00	18.85	0.02	0.00	0.00
1936	1948	18.85	18.84	0.01	0.00	0.00	18.84	0.01	0.00	0.00
1949		18.95	18.94	0.01	0.00	0.00	18.94	0.01	0.00	0.00

REMARKS: Layout is to scale as of 1934

PREPARED BY  
TRAFFIC AND PLANNING DIVISION  
IN COOPERATION WITH  
U.S. DEPARTMENT OF COMMERCE  
BUREAU OF PUBLIC ROADS

STATE OF MINNESOTA  
DEPARTMENT OF HIGHWAYS  
ROAD LIFE STUDIES  
CONSTRUCTION PROJECT LOG RECORD

CONTROL SECTION 2909  
TRUNK HIGHWAY 87  
COUNTY Hubbard  
DISTRICT 2A

LIMITS: Jct. T.H. 71 - Jct. T.H. 64

Ref. Pt. 040+00.851 - 059+00.779

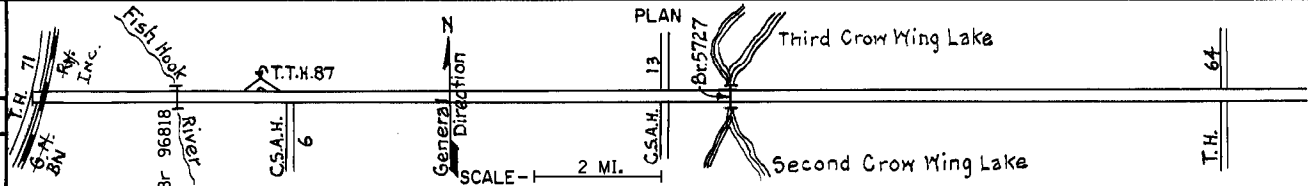

Dist No.	YEAR BUILT	PROJECT NO	DESCRIPTION			REMARKS
			TYPE	WIDTH	THICKNESS	
1560	C		Rd. Mix Bit. Surf.	24'	1"	MC-2, 84142 Gal. Agg. 6089 Tons By Maint. Dist.
	C		Bit. Resurfacing	24'	1 1/2" Added	MC-2, 49791 Gal.
	M		Bit. Surf. Repair	24'		MC-2, 44352 Gal. Road Mix 3100 Tons
	M	c	Light Bit. Seal	25'		RS-2X, 31877 Gal. Agg. 1172 C.Y.
	M	SF	Grade Lift Bit. Surf.	32' 24'	18" 1 1/2"	Gravel 2,593 Ton Bit. Mat'l. 2,300 Gal. Agg. 420 Ton
						RECLASSIFICATION OF DATA SHORTENS CONT. SEC. 0.22 MILE
1175	C	2909-04	PLATE BEAM GUARD RAIL BR'S. 5726 & 5727			563 LIN. FT.
179	C	2900-03	THREE CABLE GUARD RAIL AT M.P. 44.9			462 LIN. FT.
1980	M	1980	Bit. Surfacing		1 1/2"	200 Ton MC
1081	C	1981 2909-07	Bit. Resurfacing	24'	2" 1 1/2" Agg.	Subcuts from Sta. 627+45 to Sta. 643+55
	C	2909-10	Grading Bit. Surfacing Br. 96818	28'	2" 1 1/2"	Spec. 2331 Spec. 2341 Repl. Br. 5726
	M	2909-14	Bit. Seal Coat	24'		Fine Aggregate 2
	S	2909-13	Bit. Overlay Agg. Base Gravel Shoulder	24' 24'	4" 12"	spec 2350 Class 5
	S	2909-15	Bit Mill & Oily & Bit Oily Bit Mill & Overlay Agg. 36', 20', 6', C6 Bit Oily	24' 24'	1 1/2" 1 1/2"	24' 1 1/2" Spec 2360 Agg. Shlr 4 1/2", CI, var. Comb Shldr 4', var Grading 40

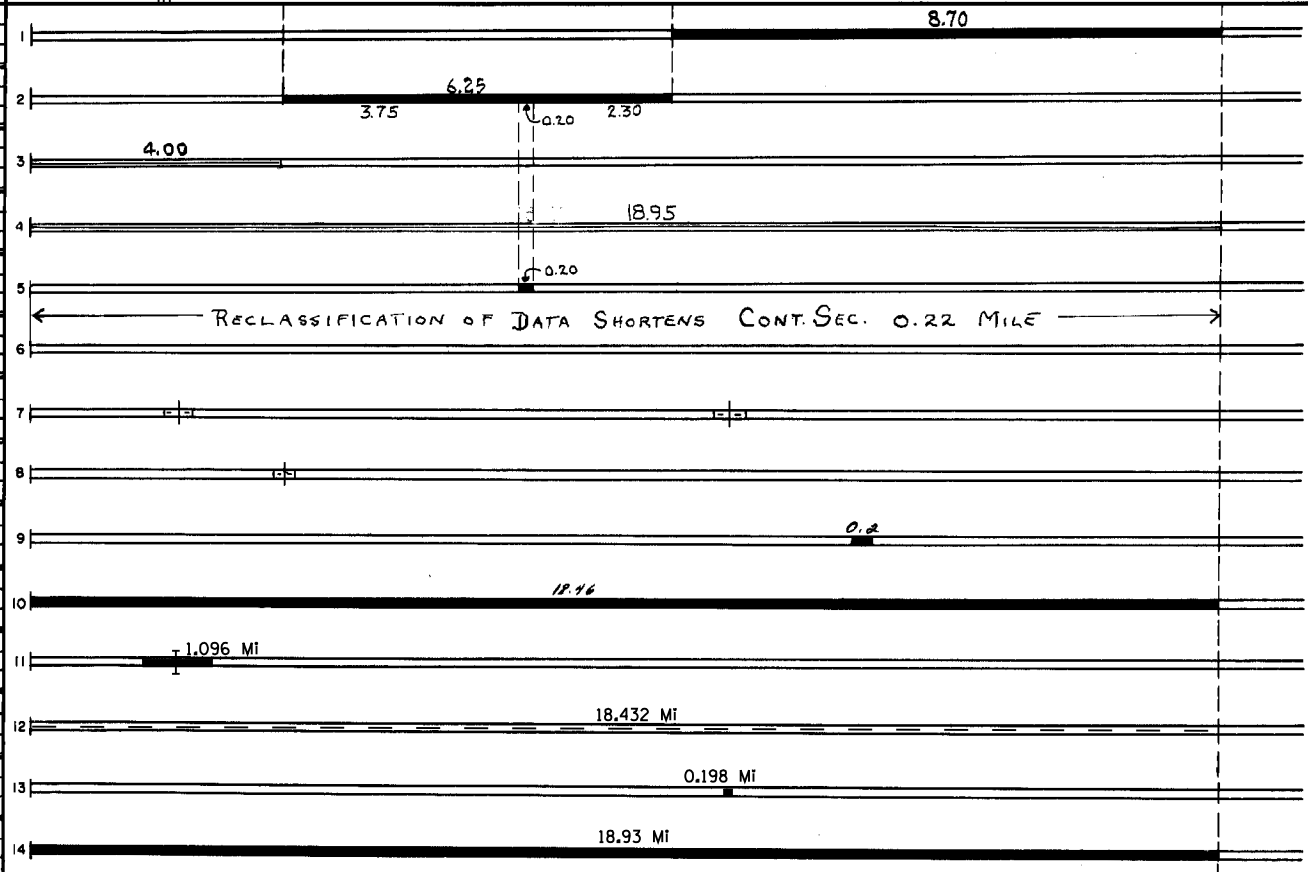

YEARS		TOTAL MILES	UNINCORPORATED		INCORPORATED		RURAL		URBAN	
FROM	TO		RDWY. MI.	BR. MI.	RDWY. MI.	BR. MI.	RDWY. MI.	BR. MI.	RDWY. MI.	BR. MI.

REMARKS: See Sheet No. 1  
FOR OTHER PROJECTS SEE DIST NO. 2170