

PREPARED BY  
HIGHWAY PLANNING SURVEY  
IN COOPERATION WITH  
U.S. PUBLIC ROADS ADMINISTRATION

STATE OF MINNESOTA  
DEPARTMENT OF HIGHWAYS  
ROAD LIFE STUDIES  
CONSTRUCTION PROJECT LOG RECORD

CONTROL SECTION 5604  
TRUNK HIGHWAY 210  
COUNTY Otter Tail  
DISTRICT 4A

LIMITS: Jct. T.H. 29 - E. Co. Line.  
Ref. Pt. 066+00.412 - 074+00.634

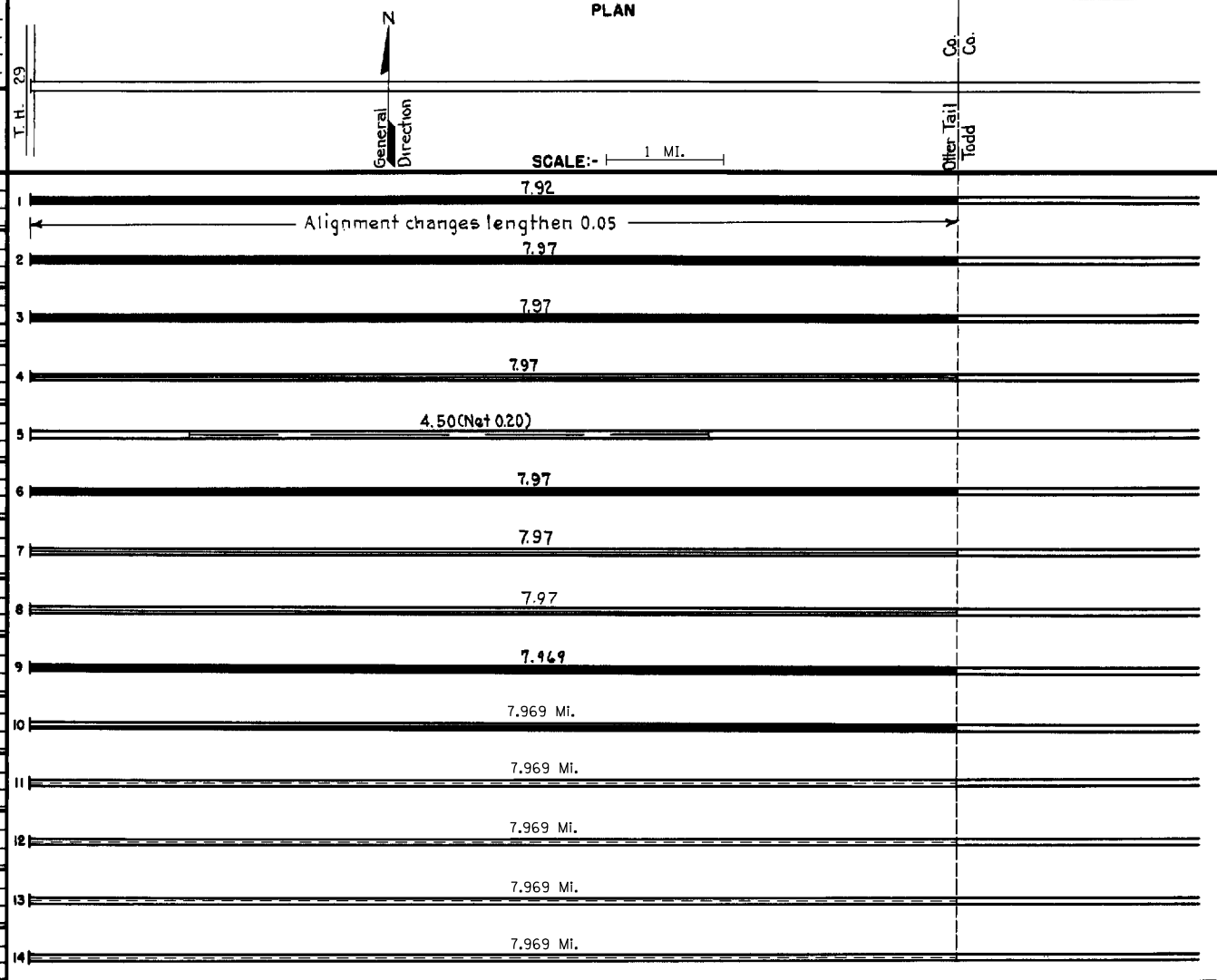

| YEAR BUILT | PROJECT N <sup>o</sup> | DESCRIPTION                      |       |           | CODE N <sup>o</sup>                         |
|------------|------------------------|----------------------------------|-------|-----------|---|
|            |                        | TYPE                             | WIDTH | THICKNESS |   |
|            |                        |                                  |       |           | No Record of Constr.                        |
|            |                        | Gravel                           | 24'   | 4"        | Added in 1934.                              |
| C<br>1947  | 5604-03                | Grading & Stab. Gravel           | 34'   | 1 1/2"    | 1200 C.Y./Mi.                               |
| C<br>1948  | 5604-04                | Mixed Bit.                       | 26'   | 1"        |   |
| M<br>1951  | A.F.E. 4               | Light Bit. Seal                  | 24'   |           | RCS-1 & MC-2, 8699 Gal. Agg. 272 C.Y.       |
| M<br>1953  | A.F.E. 604             | Spot Treat. Bit Surf. Repair     | 24'   |           | MC-3, 2273 Gal. Agg. 109 C.Y.               |
| C<br>1954  | 5604-05                | Spot Bit. Base Plant Mix Bit.    | 24'   | 2" added  | (Net Base 0.26 Mi.)                         |
| M<br>1964  | c                      | Light Bit. Seal                  | 25'   |           | RS-2K, 14075 Gal. Agg. 489 C.Y.             |
| M<br>1967  | C                      | Light Bit. Seal                  | 25'   |           | CRS-1 - Bit, 14,395 Gal. FA-1 Agg. 425 C.Y. |
| C<br>1976  | 5604-06                | Pl. Mix Bit. Surf. GRAY SHOULDER | 24'   | 3" 5'     |   |
| S<br>2000  | 5604-07                | Milling Bit. Overlay             | 24'   | 1" 28'    | Spec. 2350                                  |
| M<br>2002  | 8824-31                | Major Crack Repair               |       |           |   |
| M<br>2006  | 8824-55                | Bit. Seal Coat                   |       |           |   |
| M<br>2013  | 8824-85                | Rumble Stripes                   |       |           | Profile                                     |
| S<br>2017  | 8824-136               | Rumble Stripes Centerline        |       |           |   |

| YEARS |      | TOTAL MILES | UNINCORPORATED |         | INCORPORATED |         | RURAL     |         | URBAN     |         |
|-------|------|-------------|----------------|---------|--------------|---------|-----------|---------|-----------|---------|
| FROM  | TO   |             | RDWY. MI.      | BR. MI. | RDWY. MI.    | BR. MI. | RDWY. MI. | BR. MI. | RDWY. MI. | BR. MI. |
| 1954  | 1946 | 7.97        | 7.97           | 0.00    | 0.00         | 0.00    | 0.00      | 7.97    | 0.00      | 0.00    |
| 1947  |      | 7.97        | 7.97           | 0.00    | 0.00         | 0.00    | 0.00      | 7.97    | 0.00      | 0.00    |

REMARKS: Layout is to scale as of 1934.