

PREPARED BY  
HIGHWAY PLANNING SURVEY  
IN COOPERATION WITH  
U. S. PUBLIC ROADS ADMINISTRATION

STATE OF MINNESOTA  
DEPARTMENT OF HIGHWAYS  
ROAD LIFE STUDIES  
CONSTRUCTION PROJECT LOG RECORD

CONTROL SECTION 6003  
TRUNK HIGHWAY 2  
COUNTY Polk  
DISTRICT 2B

LIMITS: Jct.T.H. 9 - Jct.T.H. 32

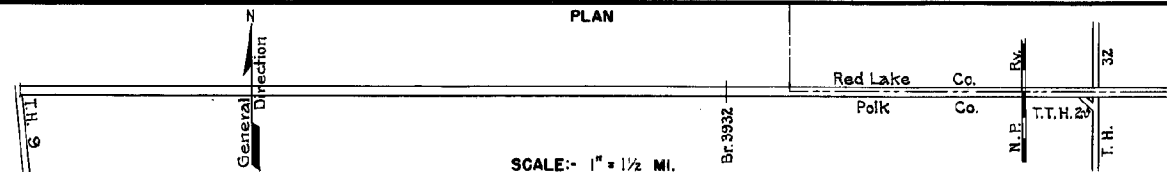

YEAR BUILT	PROJECT N <sup>o</sup>	DESCRIPTION			CODE N <sup>o</sup> DIST.
		TYPE	WIDTH	THICKNESS	
		Gravel	20'	2"	No Record of Constr.
1921	2-8-4	Gravel	20'	3"	1200 C.Y./Mile.
1921	2-8-5	Grading	24'		
1922	2-8-36	Gravel	20'	3"	1200 C.Y./Mile.
1924	2-8-41	Br. 3538			W106
1929	2-8-34	Grading	32'		
1930	2-8-34	Gravel	24'	1 1/2"	650 C.Y./Mile. Maint. Dept.
1930	2-8-50-1	Grading	44'		
1930	2-8-50-1	Concrete	20'	9-79	
1930	2-8-50-2A&B	Concrete Br. 3932	20'	9-79	230 W106D.
C	6003-01	Xing Signals			739
C	6003-08	Pt. Mix Bit Surf. Gravel Shldr.	20'	3"	Bit. Mat'l. 1379 Ton 8' Rt. & Lt. 1067
C	6003-05	Grade Base Pt. Mix Bit Surf. P.C. Concrete			Divided Highway 966
C	6003-06	Grade			on New W.B. Rdwy. 267
1969	6003-10	Gravel Base P.C. Concrete			668

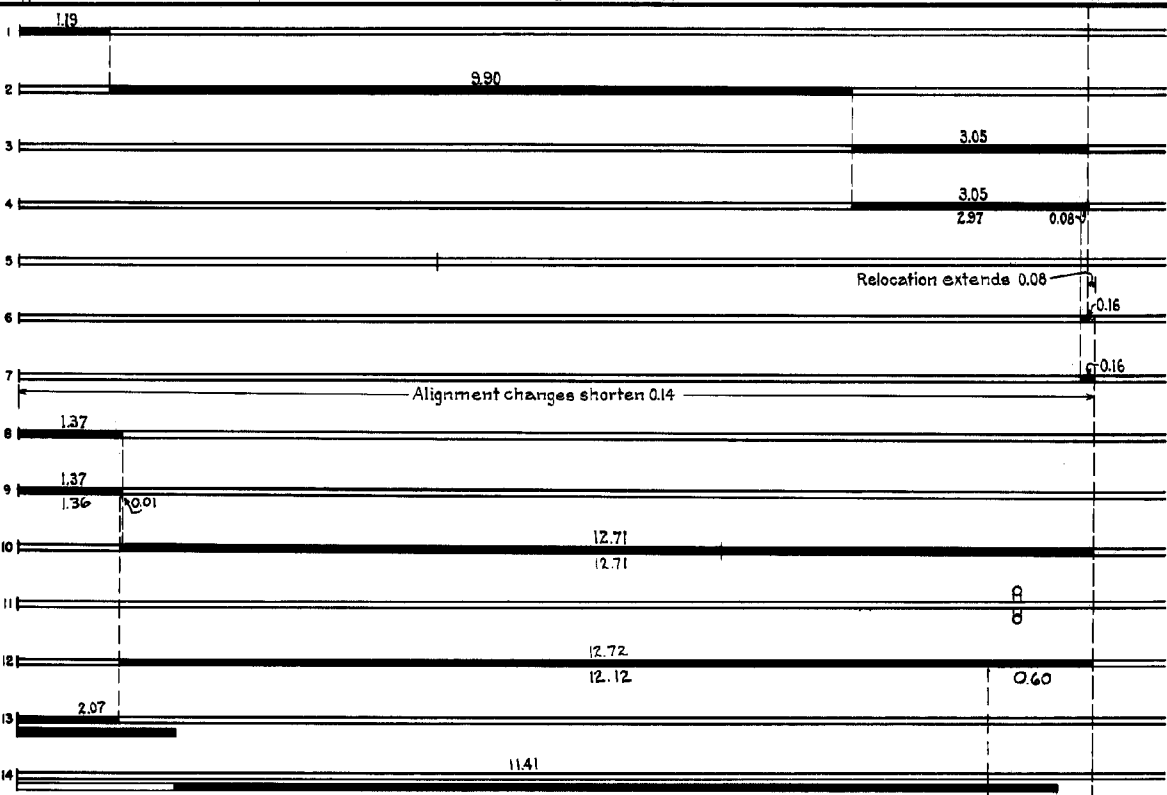

YEARS		TOTAL MILES	UNINCORPORATED		INCORPORATED		RURAL		URBAN	
FROM	TO		RDWY. MI.	BR. MI.	RDWY. MI.	BR. MI.	RDWY. MI.	BR. MI.	RDWY. MI.	BR. MI.
1921	1928	14.14	14.14	0.00	0.00	0.00	14.14	0.00	0.00	0.00
1929	1929	14.22	14.22	0.00	0.00	0.00	14.22	0.00	0.00	0.00
1930	1973	14.08	14.08	0.00	0.00	0.00	14.08	0.00	0.00	0.00
1974		14.09	14.09	0.00	0.00	0.00	14.09	0.00	0.00	0.00

REMARKS: Layout is to scale 20' of 1930

(1) This work not done under this project number but lies within the limits of this project.

4.75

PREPARED BY  
TRANSPORTATION & TRANSIT PLANNING & PROGRAMMING DIVISION  
IN COOPERATION WITH  
U.S. DEPARTMENT OF TRANSPORTATION - BUREAU OF PUBLIC ROADS

STATE OF MINNESOTA  
DEPARTMENT OF HIGHWAYS  
ROAD LIFE STUDIES  
CONSTRUCTION PROJECT LOG RECORD

CONTROL SECTION 6003  
TRUNK HIGHWAY 2  
COUNTY Polk  
DISTRICT 2B

LIMITS: Jct. T.H. 9 - Jct. T.H. 32

Ref. Pt. 028+00.934 - 043+00.038

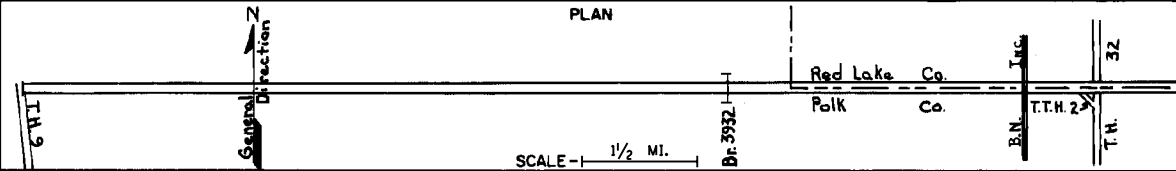

YEAR BUILT	PROJECT NO	DESCRIPTION			
		TYPE	WIDTH	THICKNESS	REMARKS
M 1971	SF	Joint Seal			84,019 Lin. Ft.
C 1974	#1(6003-1) F008-1(46)	Grade Gravel Base P.C. Concrete		6" 8"	0.93 E.B. Rdwy. 0.61 W.B. Rdwy.
C 1977	6003-14 RF REG 008	BIT SURFACE, TURN LANES, MEDIAN X-OVER AND SHOULDERING	27'	2 1/2"	ALL WORK ON EB RDWAY ONLY
C 1968	6003-12	RR CROSSING SIGNALS			WB ROADWAY
C 1979	6003-15	DRAINAGE STRUCTURE REPLACEMENT			72" CS PIPE ARCH 34 LIN. FT.
C 1974	6000-02	PLATE BEAM GUARD RAIL FOR BR. 3932			125 LIN. FT.
M 1974	SF	GRAV. SHLDR. REPAIR			AGG. 3500 YDS.
M 1978	SF	BIT. SHOULDERING			330 TON EBL 240 " WBL
M 1980	SF	Clon. Saw. and Rebar Joints in Concrete Pavement			
M 1981	SF	Bit. Surfacing Bit. Shoulders			WBL Only
M 1984	SF	Cons. Pymt. Rehabilitation Joint Repair Crack Repair			3317 Lbs. 8378 Lin. Ft. 218 Lin. Ft.
C 1985	6003-16	Bit. Overlay	24'	1 1/2" 1 1/2"	W.B. only Spec. 2331 Spec. 2341
M 1988	M4273	Joint Repair			W.B. only
C 1995	6003-23	Bit. Overlay	24'	1 1/2"	Spec 2331, 2347

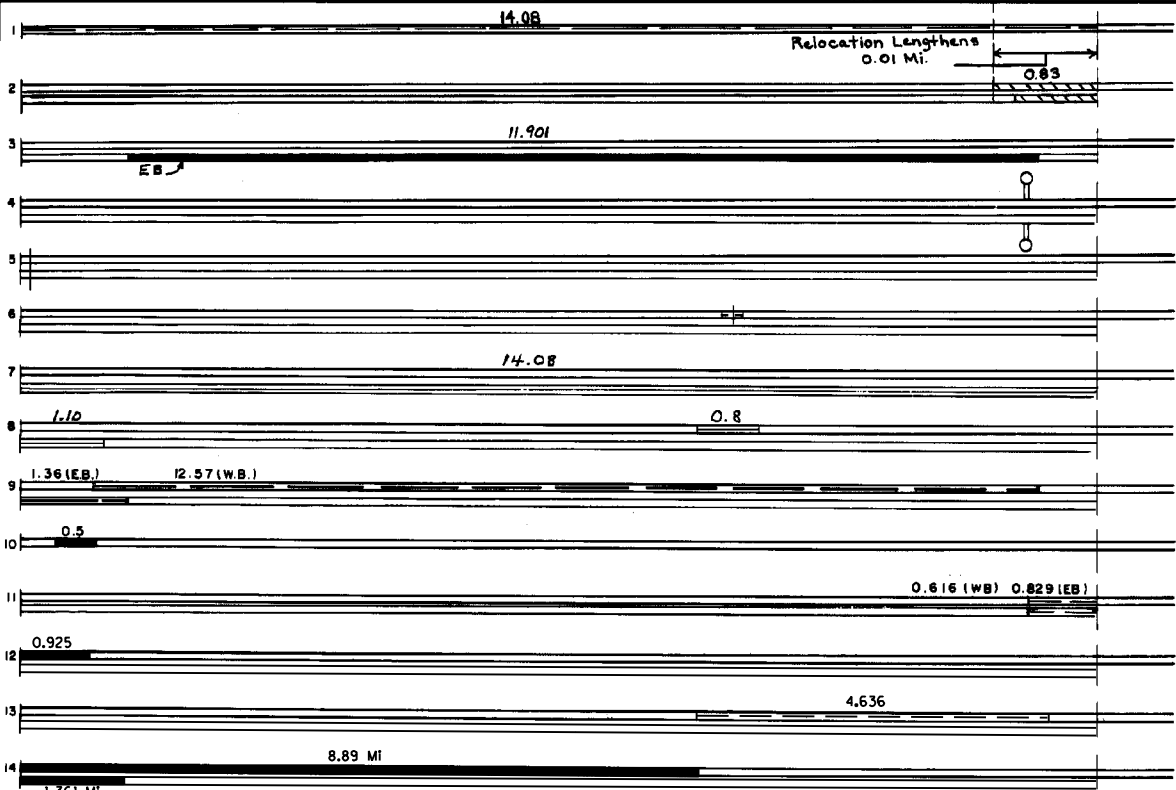

YEARS FROM	YEARS TO	TOTAL MILES	UNINCORPORATED		INCORPORATED		RURAL		URBAN	
			RDWY. MI.	BR. MI.	RDWY. MI.	BR. MI.	RDWY. MI.	BR. MI.	RDWY. MI.	BR. MI.

REMARKS: See Sheet No. 1  
Note: Line 207 Transferred to T.H. 92 CS 1204, LINE 202, C-8-80.

