

PREPARED BY
HIGHWAY PLANNING SURVEY
IN COOPERATION WITH
U.S. PUBLIC ROADS ADMINISTRATION

STATE OF MINNESOTA
DEPARTMENT OF HIGHWAYS
ROAD LIFE STUDIES
CONSTRUCTION PROJECT LOG RECORD

CONTROL SECTION 6610
TRUNK HIGHWAY 65
COUNTY Rice
DISTRICT 6B

LIMITS: N.Jct.T.H.21 - Jct.T.H.19

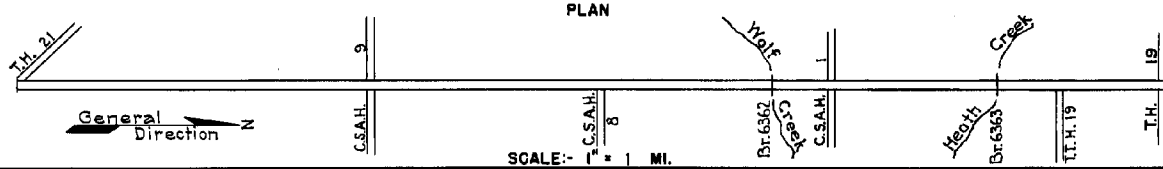

YEAR BUILT	PROJECT N ^o	DESCRIPTION			CODE N ^o
		TYPE	WIDTH	THICKNESS	
1924		Gravel	32'	3 1/2"	
		Br. 3980 & 3979	21'		
M					
1940	A.F.E. 50	Spot Graveling & Frost Boil Cor.			
	A.F.E. 78				
M					
1942	A.F.E. 6	Spot Graveling			
M					
1943	A.F.E. 6	Grav. Resurface (Spots)			
M					
1944	A.F.E. 6	Grav. Resurfacing (Spots)			
M					
1945	A.F.E. 6	Grav. Resurfacing (Spots)	32'		
M					
1947	A.F.E. 6	Grav. Resurfacing			
C					
1947	6610-02	Grading	39'		
	(1)	Stab. Gravel	39'		
		Br. 6362 & 6363 (2)			
C					
1947	6611-04	Grading	39'		
	(3)	Stab. Gravel	32'	2"	
		Extend W46 Culv.			
C					
1949	6610-07	Grading (1bt Mi.)	40'		
	(3)	Gravel Base	32'	10"	
		Plant Mix Bit.	24'	1 1/2"	
M					
1951	A.F.E. 4	Light Bit. Seal	24'		
C					
1952	6610-08	Plant Mix Bit.	24'	3"	
			added		
C					
1953	Built as Temp. Connection under S.P. 6613-02	Grading	39 1/2"		
		Sand-Gravel	39 1/2"	12"	
		Gravel	39 1/2"		
C					
1955	Built as Temp. Connection under S.P. 6613-13	Bit. Stab. Base	38 1/2"	8"	
		Plant Mix Bit.	24'	3 1/2"	

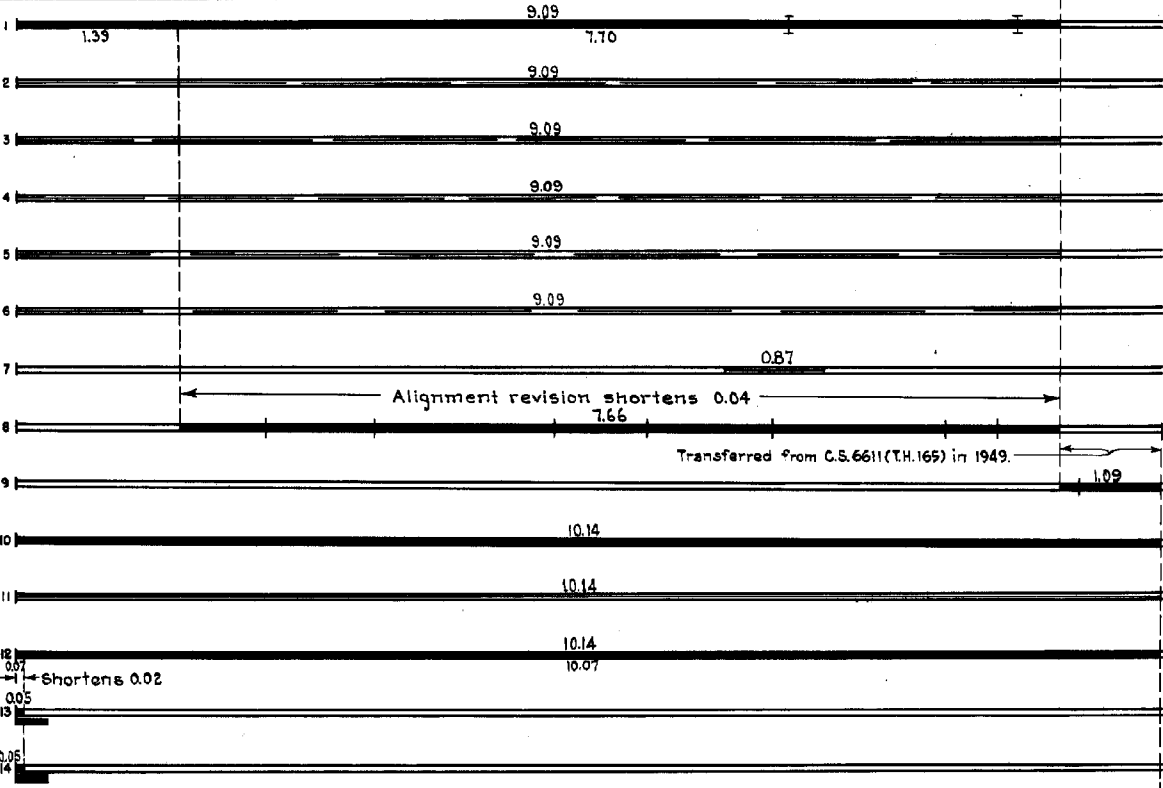

YEARS FROM	TOTAL MILES TO	UNINCORPORATED		INCORPORATED		RURAL		URBAN	
		ROWY. MI.	BR. MI.	ROWY. MI.	BR. MI.	ROWY. MI.	BR. MI.	ROWY. MI.	BR. MI.
1934	1946	9.09	0.00	0.00	0.00	9.09	0.00	0.00	0.00
1947	1948	9.05	0.00	0.00	0.00	9.05	0.00	0.00	0.00
1949	1952	10.14	0.00	0.00	0.00	10.14	0.00	0.00	0.00
1953	1964	10.12	0.00	0.00	0.00	10.12	0.00	0.00	0.00
1965		0.00	0.00	0.00	0.00	0.00	0.00	0.00	0.00

REMARKS: Layout to scale as of 1934
 (1) Contract not final but work substantially complete in 1947. (2) 2-5.C. Cattle Passes, Ext. C-46 Culv., Ext. W 46 Culv. and C-44 Culv. (3) Contract not final but work substantially complete in 1949.

