

PREPARED BY
TRAFFIC AND PLANNING DIVISION
IN COOPERATION WITH
U.S. DEPARTMENT OF COMMERCE
BUREAU OF PUBLIC ROADS

STATE OF MINNESOTA
DEPARTMENT OF HIGHWAYS
ROAD LIFE STUDIES
CONSTRUCTION PROJECT LOG RECORD

CONTROL SECTION 6925
TRUNK HIGHWAY 23 & 61
COUNTY St. Louis
DISTRICT 1A

LIMITS: (In Duluth) Grand Ave and Cody St. - N. Lim. Duluth
N. Jct. MNTH-23 E.B. - N. Lim. DULUTH

Ref. Pt. 001+00.471 - 009+00.419

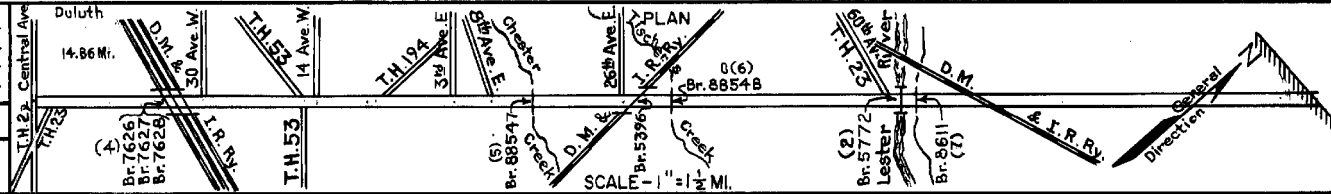

YEAR BUILT	PROJECT NO	DESCRIPTION			
		TYPE	WIDTH	THICKNESS	REMARKS
	(1)	Brick & Concrete	18'-6"		Entered System 1934 No Record of Construction
		Br. 5396	16'		P.P.C. Arch O.H. Built in 1910 48.2'
1940	6925-05	Sand Backfill Concrete		12" 9'-7'-9"	
1944	AFE 30	Bit Surf. Repair	22'	1 1/2"	
1951	AFE 27	Asphaltic Conc. over Conc. in place	44-56'	3"	
1951	6925-14	Pl. Mix Bit over Old Concrete in place Gravel Shoulders	24'-48' 8'	3"	0.07 Mi. 48' curb to Curb Rt. & Lt.
1953	AFE 828	Asphaltic Conc. Surf.		3"	
1957	AFE 618	Asphaltic Conc. & Seal	56'	1 1/2" 3"	
1961	6925-46	Asphaltic Conc. over P.C. Concrete	48'	3"	
1961	6925-38 6925-48	Grading & Gravel Base Asphaltic Conc. Traffic Signals	47' 44'	6" 3"	Curb to Curb
1963	3182 6925-54-55	Asphaltic Conc. Traffic Signals			Channelization of on P.C. Conc. in place Intersections
1965	3432	Asphaltic Conc.	40'	2 3/4"	over old P.C. Conc. in place 7 1/2-9-7 1/2
1966	6925-50 6925-57 (3)	Conc. & Gravel Base Asphaltic Conc. Traffic Signals	68' 68'	6" 3"	7" P.C. Conc. in place 10 locations
1967	6925-64	Grading, Sub-base & base P.C. Conc.	40'-56' 20' 24"	5 1/4" 8"	* Sub-base 2 @ 28' 3" base 2 @ 24' 2 1/4"
		Pl. Mix Bit Shoulders	5'-10"		

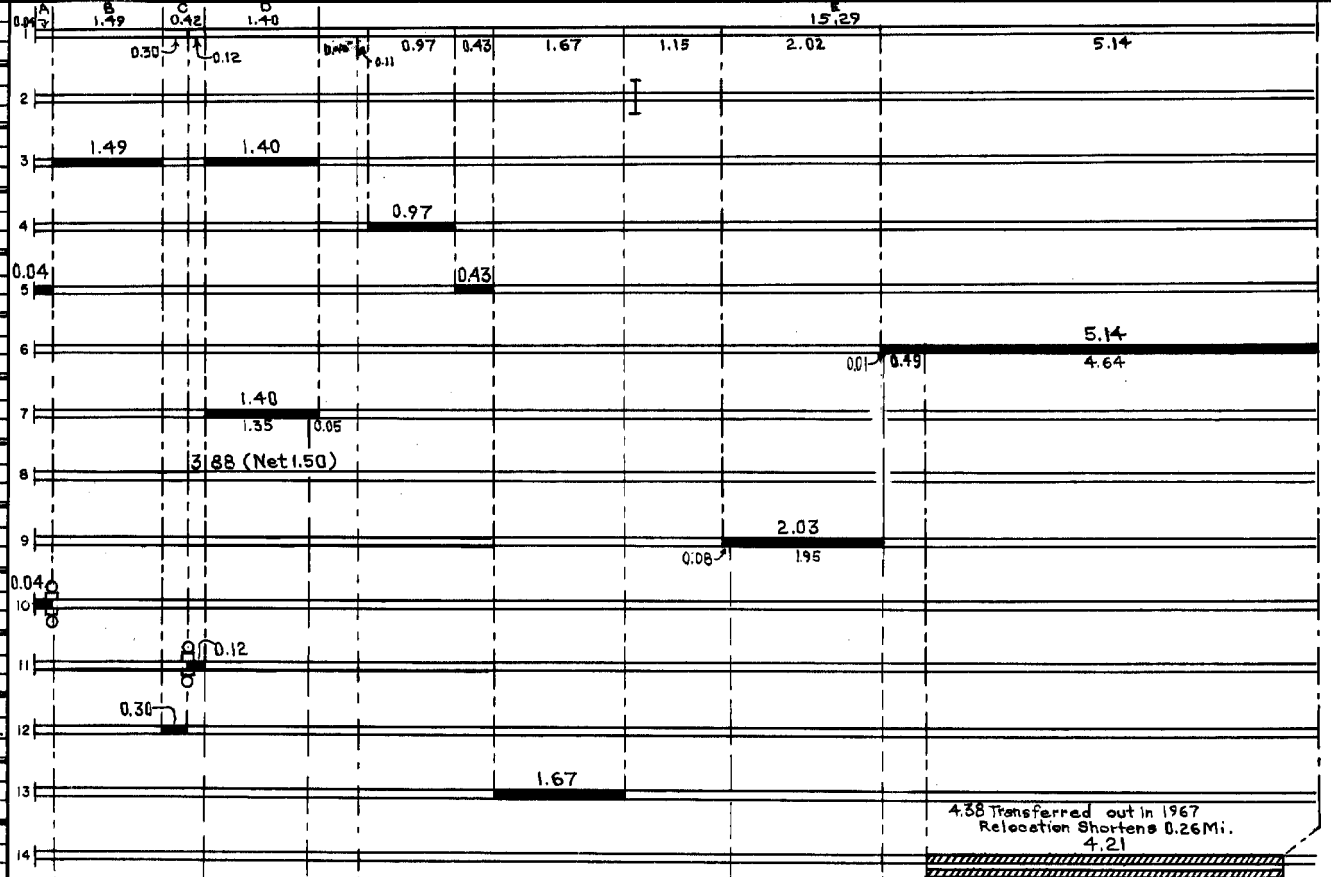

YEARS		TOTAL MILES	UNINCORPORATED		INCORPORATED		RURAL		URBAN	
FROM	TO		RDWY. MI.	BR. MI.	RDWY. MI.	BR. MI.	RDWY. MI.	BR. MI.	RDWY. MI.	BR. MI.
1934	1967	15.29	0.00	0.00	15.25	0.04	0.00	0.00	15.25	0.04
1967	1971	4.86	0.00	0.00	4.82	0.04	0.00	0.00	4.82	0.04
1972		4.82	0.00	0.00	4.78	0.04	0.00	0.00	4.78	0.04

REMARKS: Layout is to scale as of 1969.
 (1) Surface types entered in 1934: A - on Cody St. 0.04 mi. Conc.; B - on Grand Ave. 1.49 mi. Brick; C - on Carlton & Superior St. to 30th Ave W. 0.42 mi. Conc.; D - on Superior St. 1.40 mi. Brick; E - Concrete on Superior St. 0.12 mi.; on Michigan St. 0.35 mi.; on Superior St. 1.49 mi.; 4.90 mi. on London Rd. and 5.08 mi. on Condon Blvd. to the North Limits.
 (2) Br. 5772 - Conc. Arch. L=164' W=36' in place.
 (3) Located at 1st, 2nd, 3rd, 4th, 5th, 6th Ave. W., Lake Ave. and on 1st, 2nd and 3rd Ave. E.
 (4) Brs. 7626, 7627 & 7628, under D.M. & I.R. Ry.
 (5) 88547 - 11.5' culv., (6) 88548 - 16.0' culv. (7) Br. 8611 - 57.0'

PREPARED BY
TRAFFIC AND PLANNING DIVISION
IN COOPERATION WITH
U.S. DEPARTMENT OF COMMERCE
BUREAU OF PUBLIC ROADS

STATE OF MINNESOTA
DEPARTMENT OF HIGHWAYS
ROAD LIFE STUDIES
CONSTRUCTION PROJECT LOG RECORD

CONTROL SECTION 6925
TRUNK HIGHWAY 23 & 61
COUNTY St. Louis
DISTRICT 1A

LIMITS: (In Duluth) Grand Ave and Cody St. - N. Lim. Duluth
N. Jct. MNTH-23 E.B. - N. Lim. Duluth
Ref. Pt. 001+00.471 - 009+00.419

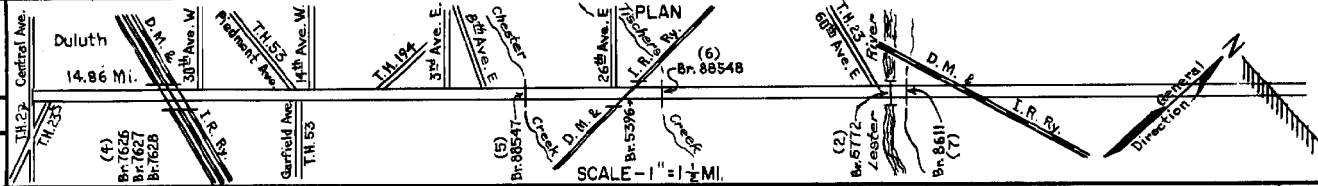

YEAR BUILT	PROJECT NO	DESCRIPTION			
		TYPE	WIDTH	THICKNESS	REMARKS
C	6925-70	R.R. Xing			*Jct. old T.H. 61 to Jct. Superior St.
	6925-71	Signal System			
	6925-71	Lighting System*			
C	6925-68	Traffic Signals			At Michigan St.
C	6925-82	Asphaltic Conc. Surface	24'-48"	5/8"	
		Gravel Shoulders			
		Grading, Conc. Base			
C	6925-59	Asphaltic Conc. Surf.	26'-52"	3"	
C	6925-81	Traffic Signals*			At 21st Ave. E.
					0.04 mi. Transferred off T.H. system in 1972
C	6925-74	GRADING CONC. BASE			0.07 MI CONC
		ASPH CONC SURF.	42'-72"		MEDIAK CONST
1972	(4)	Asphaltic Conc.	30'-48"		S.B. on 1st ST.
		Asphaltic Conc.	30'-44"		N.B. on Michigan ST.
C	6925-86	Bit. Overlay		15/6"	S.B. 1st N.B. Michigan st.
C	6925-85	TRAFFIC SIG. SYSTEM			AT SUPERIOR ST
		Foot-4 (4x2)			
C	6925-75	Pi. Mix Bit. Surf	56'	2"	
C	6925-72 R3	ASPH CONC SURF	56'	1 1/2"	
C	6925-89	ASPH. CONC.	39' 1/4" / 39' 5/8"	5/8" / 5/8"	0.30 CARLTON AV / 0.42 PIED. & SUPERIOR

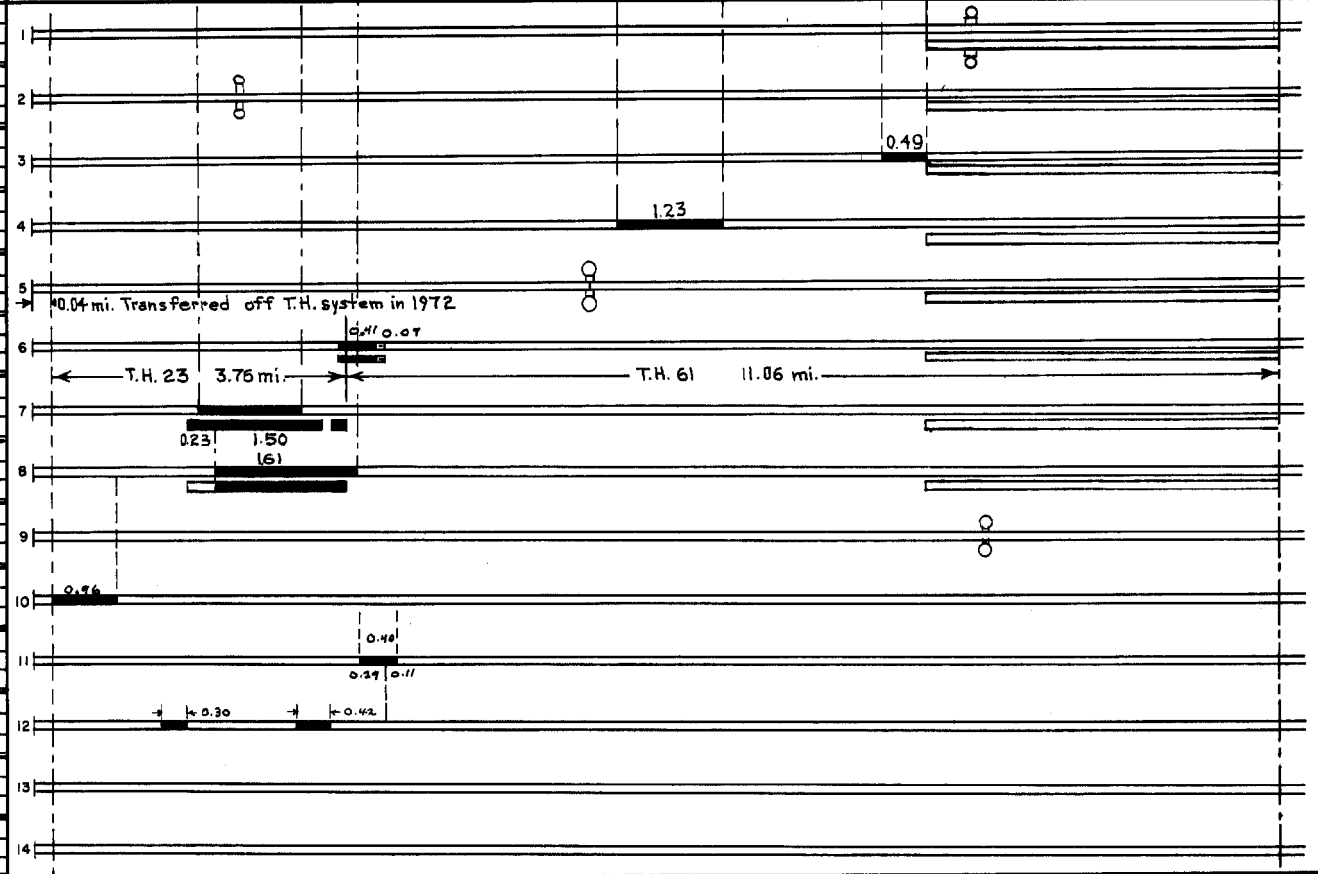

YEARS		TOTAL MILES	UNINCORPORATED		INCORPORATED		RURAL		URBAN	
FROM	TO		RDWY. MI.	BR. MI.	RDWY. MI.	BR. MI.	RDWY. MI.	BR. MI.	RDWY. MI.	BR. MI.

REMARKS: See sheet No.1
(4) South-bound on 1st St; North bound on Michigan St. (Superior St. turned back between Carlton & Piedmont)

