

PREPARED BY
HIGHWAY PLANNING SURVEY
IN COOPERATION WITH
U. S. PUBLIC ROADS ADMINISTRATION

STATE OF MINNESOTA
DEPARTMENT OF HIGHWAYS
ROAD LIFE STUDIES
CONSTRUCTION PROJECT LOG RECORD

CONTROL SECTION 6929
TRUNK HIGHWAY 73
COUNTY St. Louis
DISTRICT 1B

LIMITS: E.W. 1/4 Line Sec. 9, T.54N., R.21W. - S. Jct. T.H. 169.

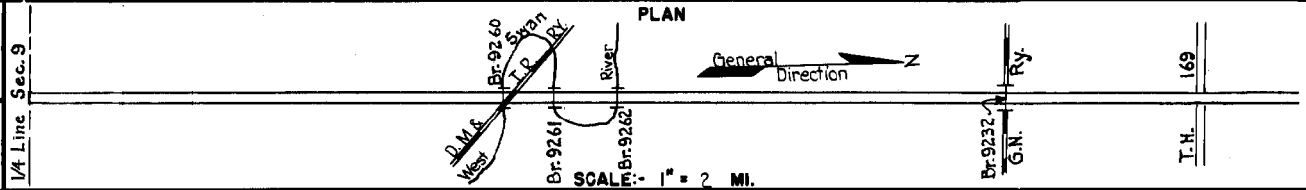

YEAR BUILT	PROJECT N°	DESCRIPTION			CODE N°
		TYPE	WIDTH	THICKNESS	
		Earth	20'		No Record of Constr. Added in 1934.
		5-Bridges (1)	16.73'		
		Gravel	20'	2"	No Record of Constr. Added in 1934.
		Gravel	20'	2"	No Record of Constr. Added in 1936.
1936		Gravel	18'	3"	Maint. Dept.
1937	A.F.E. 19	Bit Surf. Treat	24'	3/4"	Maint. Dept.
1938	A.F.E. 16	Bit Surf. Treat	24'	5/8"	Maint. Dept.
1939		Br. 8345	23'		18 B.S. Maint. Dept.
C					
1940	A.F.E. 12	Bit Surf. Treat	22'	3/4"	Maint. Dept.
M		Spot Treat.			SG3, 3162 Gal./Mi.
1940	A.F.E. 20	Bit Surf. Repair			Sand 34 C.Y./Mi. Maint. Dept.
M		Spot Treat.			SG3 & RC3, 2391 G./Mi.
1941	A.F.E. 22	Bit Surf. Repair & Fog Seal	24'		Sand 15 C.Y./Mi. Maint. Dept.
M		Spot Treat.			RC3 & MG2, 829 G./Mi.
1942	A.F.E. 4	Bit Surf. Repair	24'		Grav. 9 C.Y./Mi. Maint. Dept.
M		Spot Treat.			MC2, 224 Gal./Mi.
1943	A.F.E. 4	Bit Surf. Repair	24'		Agg. 11 C.Y./Mi. Maint. Dept.
M		Spot Treat.			MC2, 1148 Gal./Mi.
1944	A.F.E. 4	Bit Surf. Repair	24'		Agg. 19 C.Y./Mi. Maint. Div.
M		Spot Treat.			MC2, 1735 Gal./Mi.
1945	A.F.E. 4	Bit Surf. Repair	24'		Agg. 37 C.Y./Mi. Maint. Div.

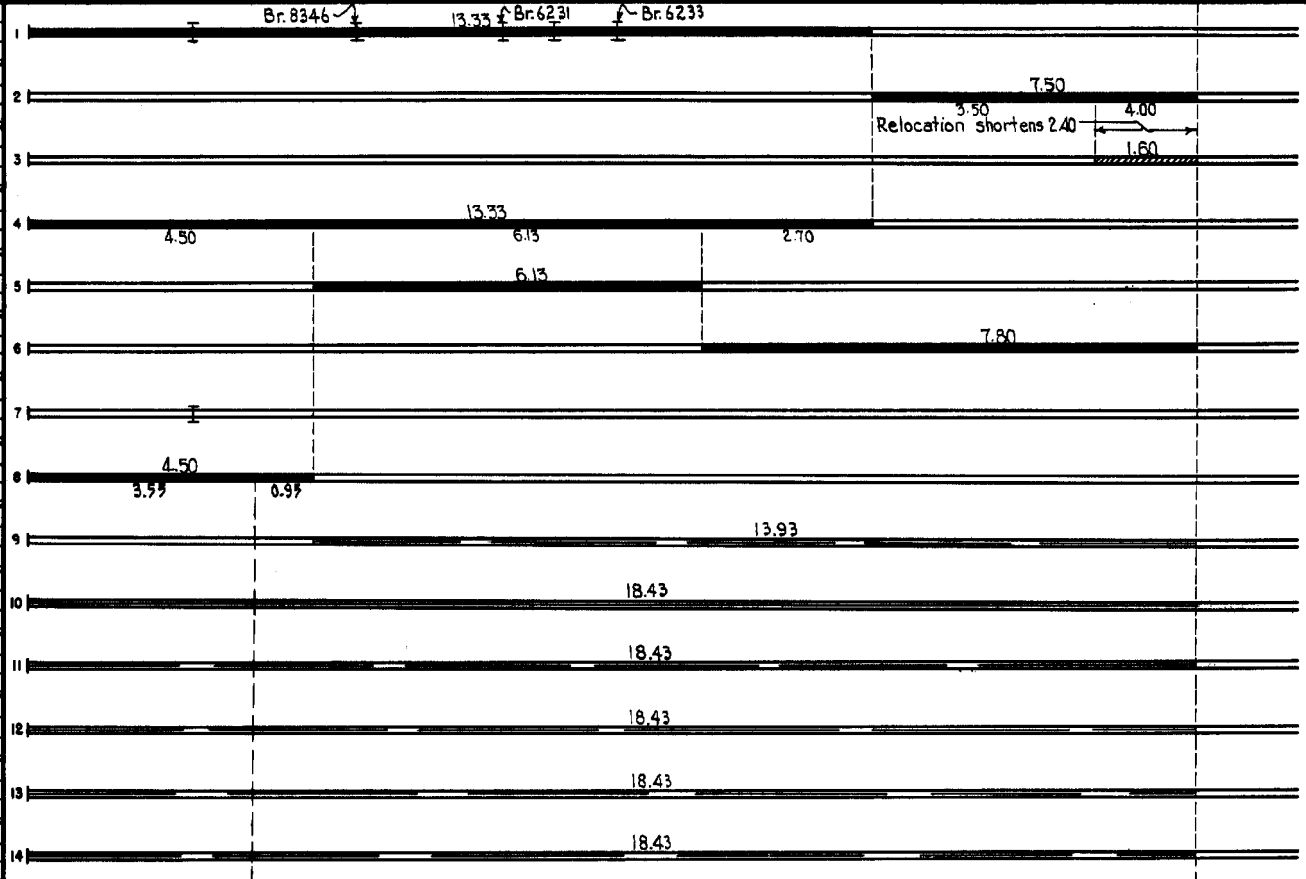

YEARS		TOTAL MILES	UNINCORPORATED		INCORPORATED		RURAL		URBAN	
FROM	TO		RDWY. MI.	BR. MI.	RDWY. MI.	BR. MI.	RDWY. MI.	BR. MI.	RDWY. MI.	BR. MI.
1934	1935	20.83	0.05	0.25	0.00	20.55	0.05	0.25	0.00	
1936	1936	18.43	0.03	0.00	0.00	18.40	0.03	0.00	0.00	
1937	1938	17.50	0.07	0.00	0.00	17.43	0.07	0.00	0.00	
1939	1939	16.80	0.07	0.00	0.00	16.73	0.07	0.00	0.00	

REMARKS: Layout is to scale as of 1936.
(1) Br. 8345, 18' Log Span; Br. 8346, 18' B.S.; Br. 6231, 50' B.S.; Br. 6232, 35' B.S.; Br. 6233, 20' C.S.

PREPARED BY
HIGHWAY PLANNING SURVEY
IN COOPERATION WITH
U.S. PUBLIC ROADS ADMINISTRATION

STATE OF MINNESOTA
DEPARTMENT OF HIGHWAYS
ROAD LIFE STUDIES
CONSTRUCTION PROJECT LOG RECORD

CONTROL SECTION 6929
TRUNK HIGHWAY 73
COUNTY St. Louis
DISTRICT 18

LIMITS: E.W. 1/4 Line Sec. 9, T54N, R.21W. - S. Jct. T.H. 169.

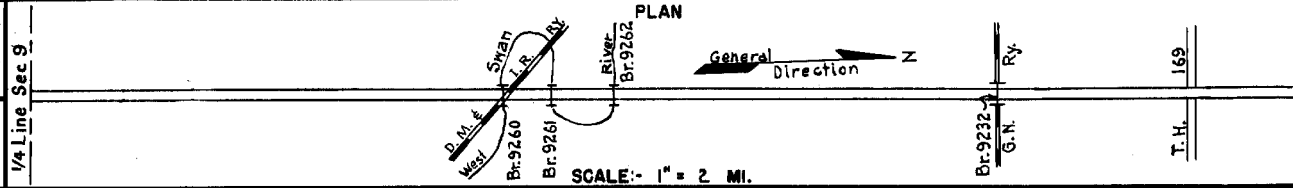

YEAR BUILT	PROJECT N ^o	DESCRIPTION			CODE N ^o
		TYPE	WIDTH	THICKNESS	
M 1946	A.F.E. 4	Spot Treat. Bit. Surf. Repair	22'		
M 1947	A.F.E. 4	Spot Treat. Bit. Surf. Repair	24'		
M 1948	A.F.E. 4	Spot Treat. Bit. Surf. Repair	24'		
M 1949	A.F.E. 4	Spot Treat. Bit. Surf. Repair & Fog Seal (Spot)	24'		
M 1950	A.F.E. 4	Spot Treat. Bit. Surface Repair Fog Seal (Spot)	24'		
M 1951	A.F.E. 4	Spot Treat. Bit. Surf. Repair			
M 1952	A.F.E. 4	Spot Treat. Bit. Surf. Repair	24'		
M 1953	A.F.E. 604 A.F.E. 821	Spot Treat. Bit. Surf. Repair Seq. Base Repairs	24'		
M 1954	A.F.E. 604	Spot Treat. Bit. Surf. Repair			
M 1955	A.F.E. 604	Spot Treat. Bit. Surf. Repair	24'		
M 1956	A.F.E. 604	Spot Treat. Bit. Surf. Repair	24'		
C 1957	6929-04 6929-02 6929-03	Grading Gravel Base Mixed Bit. (Base)	40' 40' 26'		
C 1958	6929-05	Plant Mix Bit	24' 1/2"		
C 1959	6929-07	Grading Gravel Base Mixed Bit. (Base)	48' 40' 26'		

1	18.43 (Net 5.65)
2	18.43 (Net 5.00)
3	7.80 (Net 1.20)
4	18.43 (Net Repair 5.00) (Net Fog Seal 1.50)
5	18.43 (Net Repair 3.70) (Net Fog Seal 1.75)
6	18.43 (Net 6.45)
7	18.43 (Net 5.80)
8	18.43 (Net 4.90)
9	18.43 (Net 4.70)
10	9.25 (Net 2.90)
11	13.80 (Net 4.30)
12	13.95 Relocation Shortens 0.93
13	13.95 Relocation Shortens 0.70
14	2.85 2.85

YEARS FROM	TOTAL TO	UNINCORPORATED		INCORPORATED		RURAL		URBAN	
		RDWY. MI.	BR. MI.	RDWY. MI.	BR. MI.	RDWY. MI.	BR. MI.	RDWY. MI.	BR. MI.

REMARKS: See Sheet No. 1.
(2) 3-Pre-cast channels with 32 1/2' rdwys. (Br. 9260, 93') (Br. 9261, 75') & (Br. 9262, 75') & Concrete Girder O.H. with 30' rdwy. (Br. 9232, 126')

