

PREPARED BY
HIGHWAY PLANNING SURVEY
IN COOPERATION WITH
U.S. PUBLIC ROADS ADMINISTRATION

STATE OF MINNESOTA
DEPARTMENT OF HIGHWAYS
ROAD LIFE STUDIES
CONSTRUCTION PROJECT LOG RECORD

CONTROL SECTION 7211
TRUNK HIGHWAY 169
COUNTY Sibley
DISTRICT 1A

LIMITS: S.Co.Line - E. End of Bridge 9295 (Minn. River - E.Co.Line)

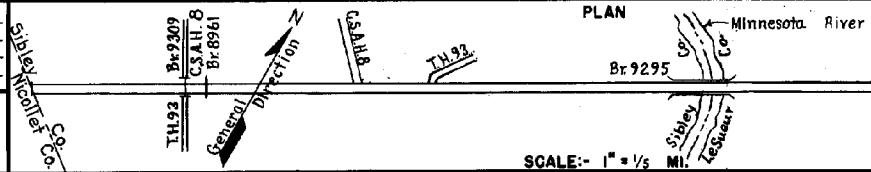

YEAR BUILT	PROJECT N°	DESCRIPTION			CODE N°
		TYPE	WIDTH	THICKNESS	
1920		Gravel	22'	2"	
1928	169-5-32-2B	Grading Gravel	32' 24'	2"	900 C.Y./Mile.
1929	169-5-32-2C	Concrete	20'	9-7-9	
C	1944 A.F.E. 16	Erosion Control of Minn. River			7537 Tons Riprap
M	1951 A.F.E. 29	Shoulder & Slope Repair			
C	1952 7211-03	Plant Mix Bit.	22'	3"	
C	1959 7211-07 7211-09	Grading Br.9295	84' 58'		Not in use until 1961 1100' B.&P.G.S.
C	1961 7211-05	Grading Sub-base Br.8961	250' 240'	6"	Divided Highway C 106 D
C	1961 7211-06 7211-11	Br.9309 Flume ext. Rip Rap			192' P.G.-U.P.
C	1962 7211-10 1966 7211-15	Gravel base P.C. Concrete Spur Dike	300' 200'	3" 8 1/2"	at Br.9295
M	1973 SF	Joint Seal			14,550 lbs Sealant
C	1979 5209-41	Revised Inplace Structure Bit. Surfacing Misc. Grading	24'	2 1/2"	
C	1981 7211-19 HES 0005(47)	Guardrail Improvement			
C	1984 4004-22 HES 101-11(10)	S.B. Rt. Turn Lane	12'	1 1/2"	At Jct. TH-93

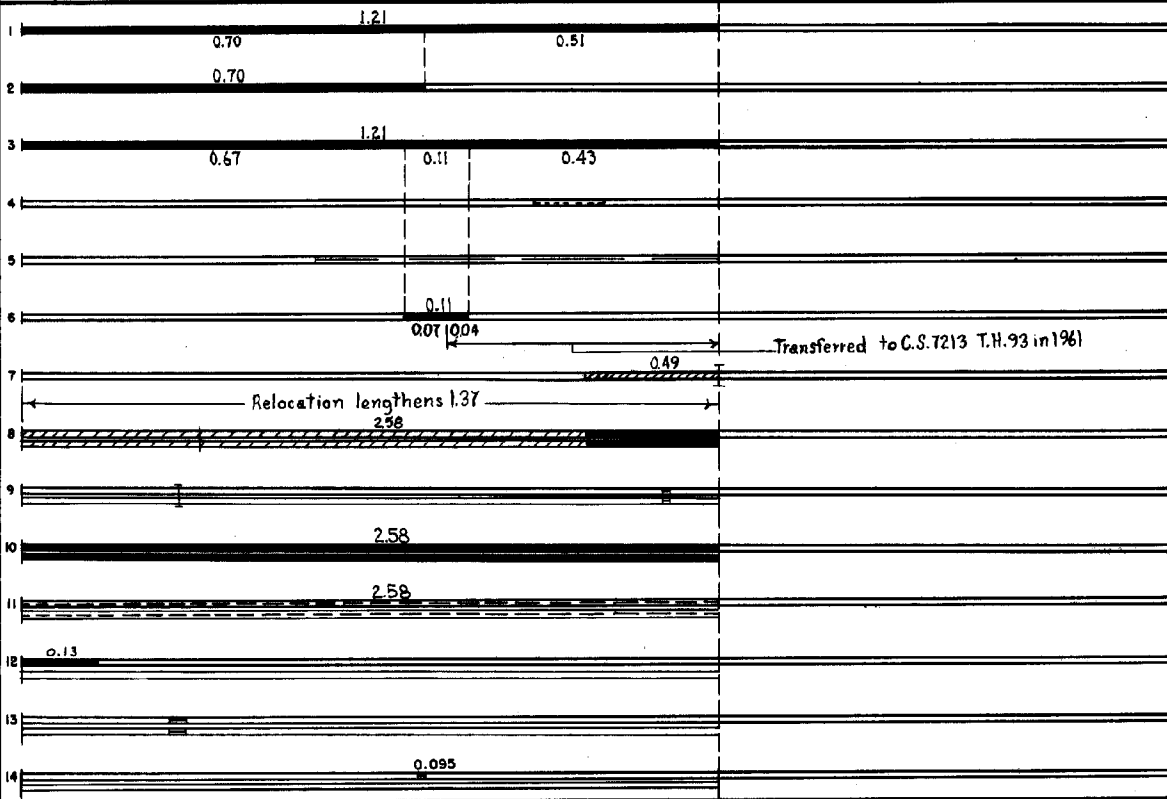

YEARS FROM	TO	TOTAL MILES	UNINCORPORATED		INCORPORATED		RURAL		URBAN	
			RDWY. MI.	BR. MI.	RDWY. MI.	BR. MI.	RDWY. MI.	BR. MI.	RDWY. MI.	BR. MI.
1921	1960	1.21	1.21	0.00	0.00	0.00	1.21	0.00	0.00	0.00
1961		2.58	2.37	0.21	0.00	0.00	2.37	0.21	0.00	0.00

REMARKS: Layout is to scale as of 1928

