

PREPARED BY
HIGHWAY PLANNING SURVEY
IN COOPERATION WITH
U.S. PUBLIC ROADS ADMINISTRATION

STATE OF MINNESOTA
DEPARTMENT OF HIGHWAYS
ROAD LIFE STUDIES
CONSTRUCTION PROJECT LOG RECORD

CONTROL SECTION 7406
TRUNK HIGHWAY 65
COUNTY Steele
DISTRICT 6B

LIMITS: S. Co. Line - S. Jct. T.H. 218

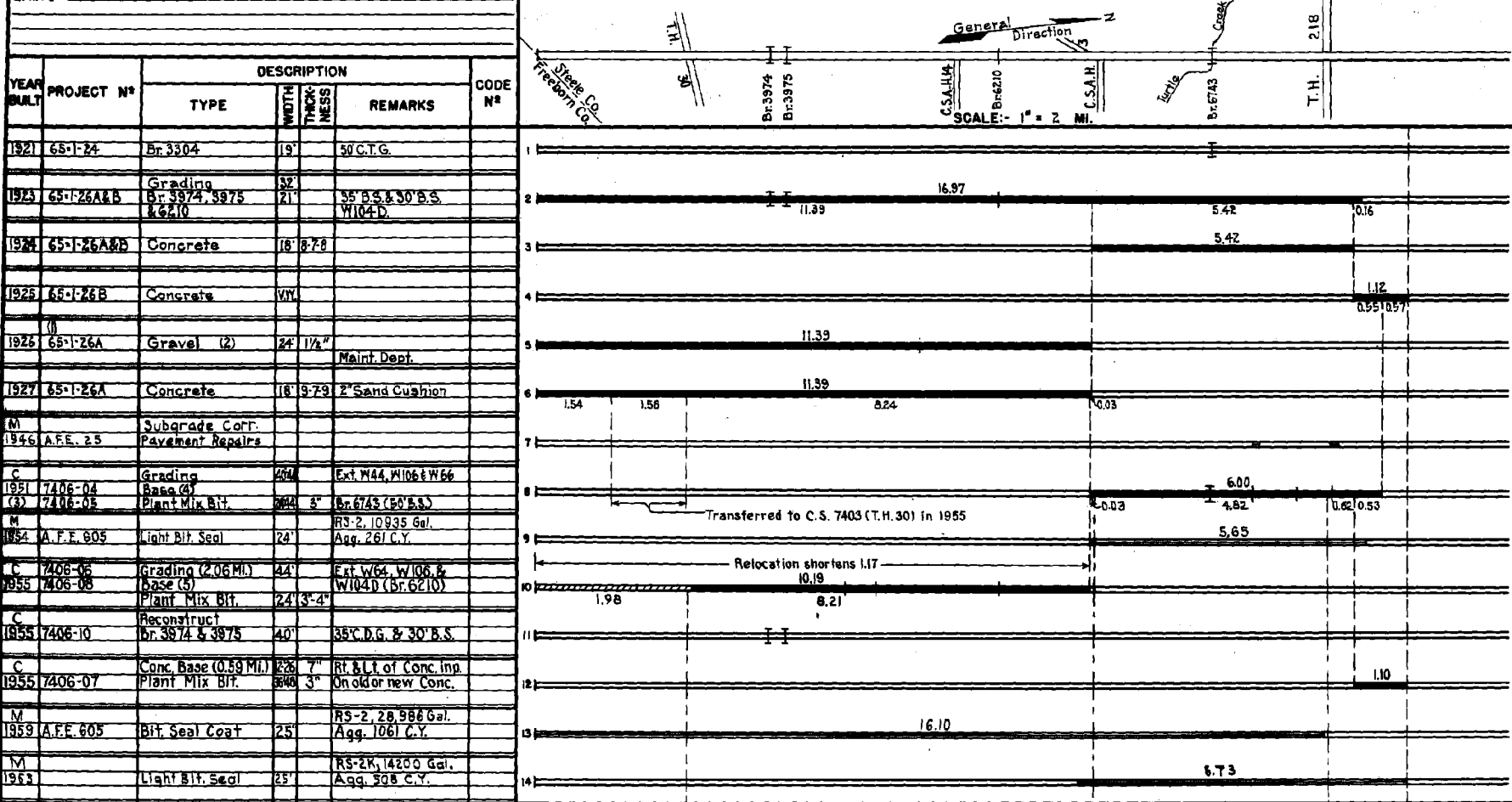

YEAR BUILT	PROJECT N ^o	DESCRIPTION			CODE N ^o
		TYPE	WIDTH	THICKNESS	
1921	65-1-24	Br. 3504	19'	50 C.T.G.	
1923	65-1-26A&B	Grading Br. 3974, 3975 & 6210	32' 21'	35' B.S. & 30' B.S. W104D.	
1924	65-1-26A&B	Concrete	18' 8-7/8		
1925	65-1-26B	Concrete	WV		
1926	65-1-26A	Gravel (2)	24' 1 1/2"	Maint. Dept.	
1927	65-1-26A	Concrete	18' 9-29	2" Sand Cushion	
M	1946 A.F.E. 23	Subgrade Corr. Pavement Repairs			
C	1951 7406-04	Grading	40'	Ext. W44, W106 & W66	
(3)	7406-05	Base (4) Plant Mix Bit.	30' 3"	Br. 6743 (50' B.S.)	
M	1954 A.F.E. 905	Light Bit. Seal	24'	RS-2, 10935 Gal. Agg. 261 C.Y.	
C	7406-06	Grading (2.06 Mi.)	44'	Ext. W64, W106 & W104D (Br. 6210)	
1955	7406-08	Base (5) Plant Mix Bit.	24' 3-4"		
C	1955 7406-10	Reconstruct br. 3974 & 3975	40'	35' C.D.G. & 30' B.S.	
C	1955 7406-07	Conc. Base (0.59 Mi.) Plant Mix Bit.	23' 7" 30' 3"	Rt. & Lt. of Conc. imp. On old or new Conc.	
M	1959 A.F.E. 605	Bit. Seal Coat	25'	RS-2, 28,986 Gal. Agg. 1061 C.Y.	
M	1963	Light Bit. Seal	25'	RS-2K, 14200 Gal. Agg. 508 C.Y.	

FROM	TO	TOTAL MILES	UNINCORPORATED		INCORPORATED		RURAL		URBAN	
			RDWY. MI.	BR. MI.	RDWY. MI.	BR. MI.	RDWY. MI.	BR. MI.	RDWY. MI.	BR. MI.
1921	1954	17.93	16.66	0.02	1.25	0.00	16.66	0.02	1.25	0.00
1955	1955	16.76	15.49	0.02	1.25	0.00	15.49	0.02	1.25	0.00
1959	1963	16.76	15.35	0.02	1.39	0.00	15.35	0.02	1.39	0.00
1964	1966	16.76	15.24	0.02	1.50	0.00	15.24	0.02	1.50	0.00
1966	1966	19.04	19.02	0.02	0.00	0.00	19.02	0.02	0.00	0.00
1967		0.00	0.00	0.00	0.00	0.00	0.00	0.00	0.00	0.00

REMARKS: Layout is to scale as of 1925

(1) This work not done under this project number but lies within the limits of this project. (2) Gravel placed by Maint. Dept. over a period of two years. (3) Contract not final but work substantially complete. (4) 60% Bit. Seal (2") on old conc. or 6" (Min) sub-base, balance old 18" conc. which was widened to 25'-4" with 12" Bit. Stab. Base. (5) 76% is 6' x 44' Bit. Stab. Base on 12"-16" Sand-Grav. Sub-base, balance old conc. base widened with 6" Plant Mix Bit. Base

PREPARED BY
 TRAFFIC AND PLANNING DIVISION
 IN COOPERATION WITH
 U.S. DEPARTMENT OF COMMERCE
 BUREAU OF PUBLIC ROADS

STATE OF MINNESOTA
 DEPARTMENT OF HIGHWAYS
 ROAD LIFE STUDIES
 CONSTRUCTION PROJECT LOG RECORD

CONTROL SECTION 7406
 TRUNK HIGHWAY 65
 COUNTY Steele
 DISTRICT 6B

LIMITS: S. Co. Line - Jct. T.H. 21B

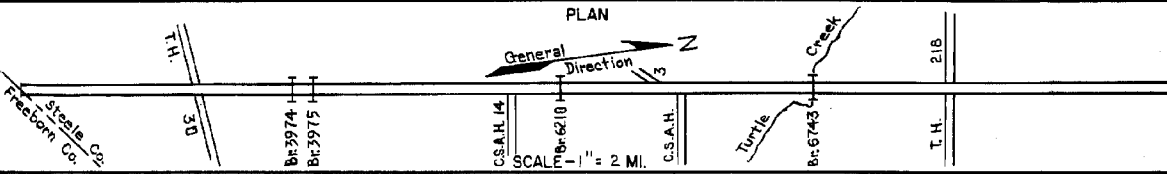

YEAR BUILT	PROJECT NO	DESCRIPTION TYPE	WIDTH		REMARKS
			WIDTH	THICKNESS	
1964	C	Plant Mix Bit. Grav. Shoulders	24' 20'	3" 3"	10' Rt. & Lt.
1966	Maint. Proj.	Plant Mix Bit. Gravel Shoulders	24'	2 1/2"	
1966	7408-08&10	Grading, Sub-base* Gravel & Bit. Base Plant Mix Bit.		*12" 4' & 1" 3 1/2"	

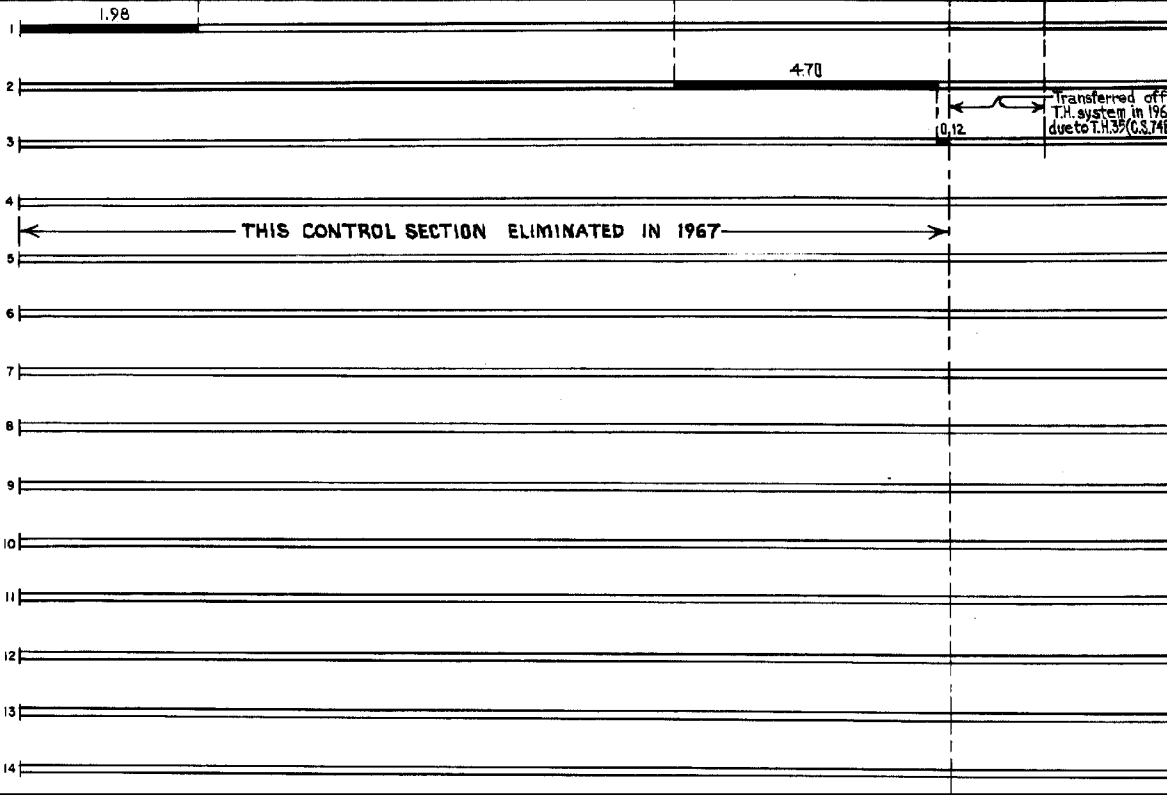

YEARS FROM	YEARS TO	TOTAL MILES	UNINCORPORATED		INCORPORATED		RURAL		URBAN	
			RDWY. MI.	BR. MI.	RDWY. MI.	BR. MI.	RDWY. MI.	BR. MI.	RDWY. MI.	BR. MI.

REMARKS: See Sheet No 1