

PREPARED BY
HIGHWAY PLANNING SURVEY
IN COOPERATION WITH
U.S. PUBLIC ROADS ADMINISTRATION

STATE OF MINNESOTA
DEPARTMENT OF HIGHWAYS
ROAD LIFE STUDIES
CONSTRUCTION PROJECT LOG RECORD

CONTROL SECTION 8711
TRUNK HIGHWAY 75
COUNTY Yellow Medicine
DISTRICT 8B

LIMITS: Jct. T.H. 68 in Canby - N. Co. Line.

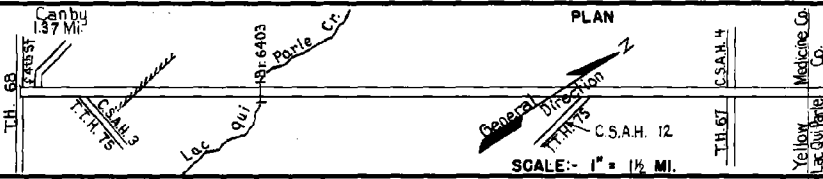

| YEAR BUILT | PROJECT N ^o | DESCRIPTION | | CODE N ^o |
|------------|------------------------|---------------------------------------|-----------------|--|
| | | TYPE | WIDTH THICKNESS | |
| | | Gravel | 22' 2" | No Record of Constr. |
| 1919 | 75-6-1 | Grading Br. 3256 (1) | 24' 18' | Co. Job 1902 40 B.S. |
| | (2) | | | No Record of Constr. Status Map shows Gravel in 1920 |
| 1920 | 75-6-1 | Gravel | 24' 2" | 1200 C.Y./Mile |
| 1920 | 75-6-20K | Gravel | 24' 2 1/2" | 1200 C.Y./Mile |
| 1921 | 75-6-2 | Gravel | 24' 2 1/2" | 1200 C.Y./Mile |
| | | Gravel | 24' 2" | Transferred from T.H. 67 in 1930. 16 B.S. |
| | | Gravel | 24' 2" | No Record of Constr. Taken over from County in 1930. |
| 1926 | 75-48-21 | Br. 4523 | 24' | 90 B.S. Transferred from T.H. 67 in 1930. |
| 1931 | | Tar Tr. Gravel | 36' | 10000 Gal./Mile Maint. Dept. |
| 1931 | | Tar Tr. Gravel | 20' 1" | 10000 Gal./Mile 16 B.S. |
| M | | Spot Treat. | | SG-4-1820 Gal./Mi. |
| 1941 | A.F.E. 33 | Bit. Surf. Repair | 26' | Grav. 74 CY/Mi. Maint. Dept. |
| M | | | | MG-3-2733 Gal./Mi. |
| 1942 | A.F.E. 4 | Bit. Retreat | 24' | Grav. 194 CY/Mi. Maint. Dept. |
| C | | | | |
| 1942 | 8711-04 | Br. 6403 | 30' | 50' C.D.G. |
| C | | | | |
| 1943 | 8711-02 | Grading Stab. Gravel 5-Culverts | 36' 36' | 1337 C.Y./Mile. |

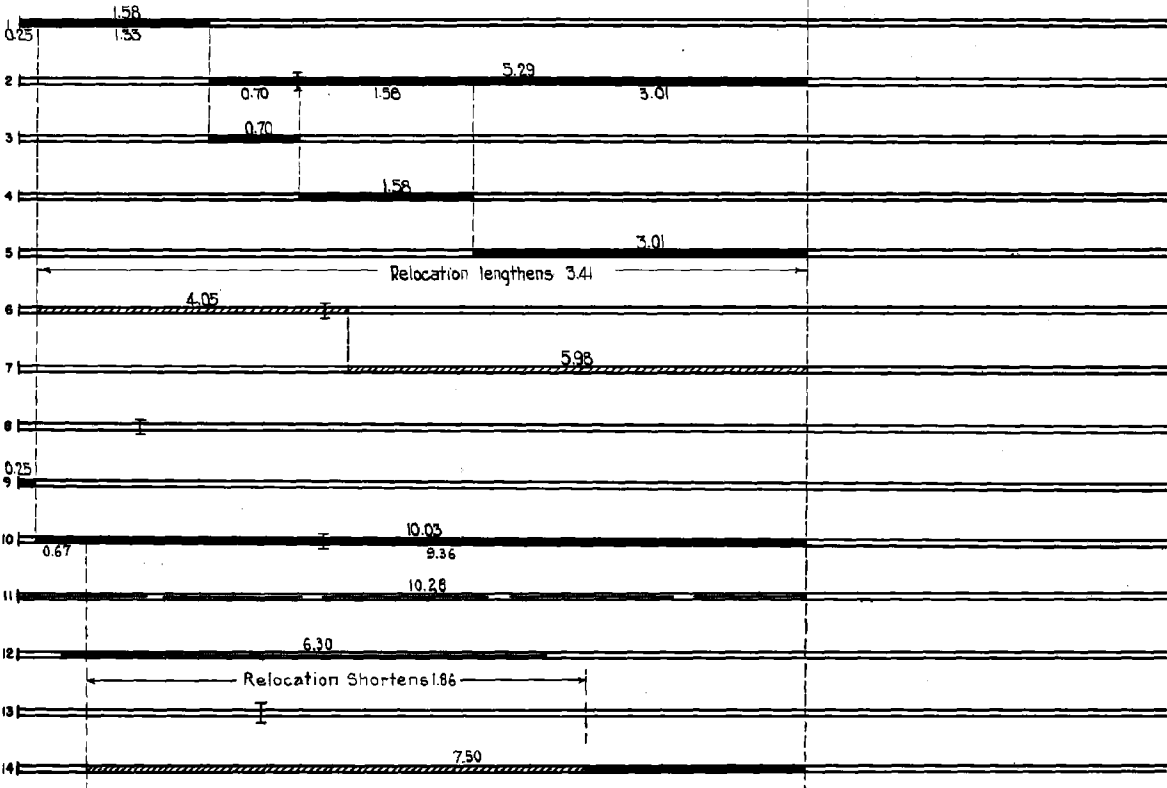

| YEARS | | TOTAL MILES | UNINCORPORATED | | INCORPORATED | | RURAL | | URBAN | |
|-------|------|-------------|----------------|---------|--------------|---------|-----------|---------|-----------|---------|
| FROM | TO | | RDWY. MI. | BR. MI. | RDWY. MI. | BR. MI. | RDWY. MI. | BR. MI. | RDWY. MI. | BR. MI. |
| 1921 | 1929 | 5.57 | 5.51 | 0.01 | 1.35 | 0.00 | 5.51 | 0.01 | 1.35 | 0.00 |
| 1930 | 1942 | 10.25 | 9.00 | 0.02 | 1.26 | 0.00 | 9.00 | 0.02 | 1.26 | 0.00 |
| 1943 | 1950 | 8.42 | 7.05 | 0.01 | 1.36 | 0.00 | 7.05 | 0.01 | 1.36 | 0.00 |
| 1951 | | 8.43 | 7.05 | 0.01 | 1.37 | 0.00 | 7.05 | 0.01 | 1.37 | 0.00 |

REMARKS: Layout is to scale as of 1930.
(1) No record of construction of Br. 3256.
(2) This work not done under this project number but lies within the limits of this project.

PREPARED BY
HIGHWAY PLANNING SURVEY
IN COOPERATION WITH
U.S. PUBLIC ROADS ADMINISTRATION

STATE OF MINNESOTA
DEPARTMENT OF HIGHWAYS
ROAD LIFE STUDIES
CONSTRUCTION PROJECT LOG RECORD

CONTROL SECTION 8711
TRUNK HIGHWAY 75
COUNTY Yellow Medicine
DISTRICT 8B

LIMITS: Jct. T.H. 68 in Canby - N. Co. Line.
Ref. Pt. 086+00.381 - 094+00.812

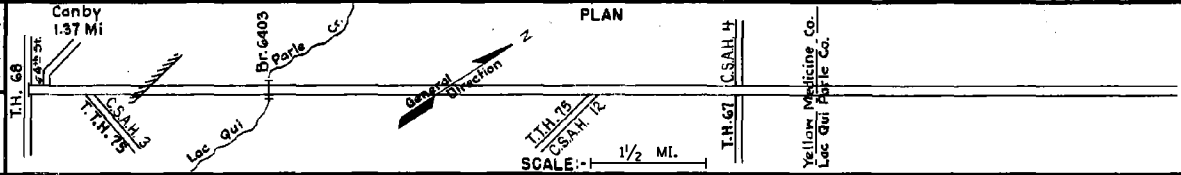

| YEAR BUILT | PROJECT N° | DESCRIPTION | | | CODE N° |
|------------|-----------------------------|--|---------------|--------------|---------|
| | | TYPE | WIDTH | THICKNESS | |
| C | A.F.E. 7 | Seeding | | | |
| M | 1943 A.F.E. 6 | Grav. Resurface | | | |
| M | 1945 A.F.E. 6 | Grav. Resurfacing | | | |
| M | 1945 A.F.E. 5 | Bit. Seal Coat | | | |
| C | 1946 A.F.E. 10 | Bit. Surfacing Bit. Surf. Treat. | 24' | 3/4" | |
| M | 1947 A.F.E. 4 | Spot Treat Bit. Surf. Repair | | | |
| M | 1948 A.F.E. 4 | Spot Treat Bit. Surf. Repair | 24' | | |
| M | 1949 A.F.E. 4 | Spot Treat Bit. Surf. Repair | 24' | | |
| M | 1950 A.F.E. 4 | Spot Treat Bit. Surf. Repair | 24' | | |
| C | 1951 8711-07 (8) 8711-09 | Concrete (0.98 Mi.) Concrete Shouldering | 44' 8" 22' | 8" 9'-9" | |
| M | 1971 SF | Joint Seal | | | |
| M | 1989 M4350 | Spot Overlay | 2" | | |
| C | 1992 8711-12 | Bit. Overlay | 28' | 1 1/2" 3" | |
| M | 1994 94118 | Edge Drains | | | |

| | | | | |
|----|------|--|-----------------|------------------------------------|
| 1 | | | | |
| 2 | | | 4.73 | |
| 3 | | | 7.50 | |
| 4 | 0.92 | | | |
| 5 | | | 7.50 | |
| 6 | | | 8.42 (Net 1.30) | |
| 7 | | | 8.42 (Net 2.15) | |
| 8 | | | 8.42 (Net 4.00) | |
| 9 | | | 8.42 (Net 4.20) | |
| 10 | | | 8.43 | Lengthens 0.01 due to former error |
| 11 | | | 5.00 | |
| 12 | | | 0.692 | |
| 13 | | | 6.526 | |
| 14 | | | 0.922 | |

| YEARS FROM | TOTAL MILES TO | UNINCORPORATED | | INCORPORATED | | RURAL | | URBAN | |
|------------|----------------|----------------|---------|--------------|---------|-----------|---------|-----------|---------|
| | | RDWY. MI. | BR. MI. | RDWY. MI. | BR. MI. | RDWY. MI. | BR. MI. | RDWY. MI. | BR. MI. |
| | | | | | | | | | |
| | | | | | | | | | |
| | | | | | | | | | |

REMARKS: See Sheet No. 1
(3) Contract not final but work substantially complete

